

TOTAL EXTENT (LEAST EXTENT AS PER DOCUMENT) : 3885 SQ.M
ROAD AREA : 1329 SQ.M
NO.OF.PLOTS : 25 Nos.

NOTE:

1. SPLAY-1.5M X 1.5M
2. MEASUREMENTS ARE INDICATED EXCLUDING SPLAY DIMENSIONS
3.  ROAD AREA WAS HANDED OVER TO THE LOCAL BODY
 VIDE GIFT DEED DOCUMENT NO. 4804 / 2018, DATE: 20 / 04 / 2018, @ SRO KUNDRATHUR

CONDITIONS :

(I)THE FOLLOWING CONDITIONS OF CMWSSB VIDE THE CE (O&M) II CHINTADRIPET, CHENNAI -2. LETTER NO.CMWSSB / O&M III / WT & T / 530 MLD / NOC / 2018, DATE:04.01.2018. ARE TO BE COMPLIED BY THE APPLICANT BEFORE ISSUING OF THE LAYOUT APPROVAL BY THE COMPETENT AUTHORITY (LOCAL BODY)





1. RCC COMPOUND WALL SHALL BE CONSTRUCTED ON THE BOUNDARIES OF THE PROPOSED LAND ADJACENT TO CMWSSB LAND WITH GATE PROVISIONS OF 6m. SPAN AT BOTH ENDS AS ACCESSES TO REACH THE OTHER SIDE OF THE PROPOSED DEVELOPMENT.
2. A CULVERT HAS TO BE PROVIDED OVER THE EXISTING 2000mm DIA WATER MAIN IN ORDER TO PROTECT THE SAME FROM HEAVY VEHICLE IN THE ACCESS PERMITTED. THE COST OF THE CULVERT WILL BE INFORMED SHORTLY.
3. THE APPLICANT ARE REQUESTED TO DEPOSIT THE COST OF THE CULVERT TO CMWSS BOARD FOR TAKING UP THE WORK.
4. ONLY ON COMPLETION OF THE CONSTRUCTION OF BOX CULVERT ACTUAL ACCESS WILL BE PROVIDED.
- 5.IF ANY LEAK OR BURST OCCURS IN THE PIPELINE IN FUTURE WITHIN THE CULVERT PORTION,THE CULVERT WILL BE DEMOLISHED BY THE BOARD FOR ATTENDING LEAK / BURST IN FUTURE AND THE SAME HAS TO BE RECONSTRUCTED AT APPLICANT RISK AND COST.
6. THE APPLICANT SHOULD NOT HAVE ANY RIGHTS, WHATSOEVER TO CLAIM THE OWNERSHIP OF THE ABOVE BOARD'S LAND OR THE CULVERT.
- 7.THE BOARD IS RESERVES THE RIGHT TO ENTER UPON THE PREMISES FOR ANY INSPECTION AND TO CANCEL THE PERMISSION AT ANY POINT OF TIME WITHOUT ASSIGNING ANY REASON IN THE INTEREST OF PUBLIC.
8. THE APPLICANT SHOULD INCLUDE IN THE SALE DEEDS TO BE EXECUTED FOR REGISTRATION THAT THE PURCHASERS SHALL OBEY ALL TERMS AND CONDITIONS STIPULATED BY CMWSS BOARD TO M/S.SUGALI ENTERPRISES PVT.LIMITED,AVAILING THE RIGHT OF WAY."
9. THE APPLICANT SHOULD FURNISH THE COPIES OF THE SALE DEEDS TO THE CMWSS BOARD.

(II)LOCAL BODY SHOULD ENSURE COMPLIANCE OF ALL THE CONDITIONS STIPULATED BY CMWSSB IN THEIR LETTER NO.CMWSSB / O&M II / WT & T / 530 MLD / NOC / 2018, DATE:04.01.2018. AND SHALL OBTAIN A LETTER FROM CMWSSB CONFIRMING THE COMPLIANCE OF THE CONDITIONS BEFORE THE SANCTION AND RELEASE OF THE LAYOUT.

(III) DR RULE NO: 29 (11)

THE COST OF LAYING IMPROVEMENTS TO THE SYSTEMS IN RESPECT OF ROAD, WATER SUPPLY, SEWERAGE, DRAINAGE OR ELECTRIC POWER SUPPLY THAT MAY BE REQUIRED AS ASSESSED BY THE COMPETENT AUTHORITY, SHALL BE BORNE BY THE APPLICANT.

LEGEND:

-  SITE BOUNDARY
-  ROADS GIFTED TO LOCAL BODY
-  EXISTING ROAD
-  CHANNEL

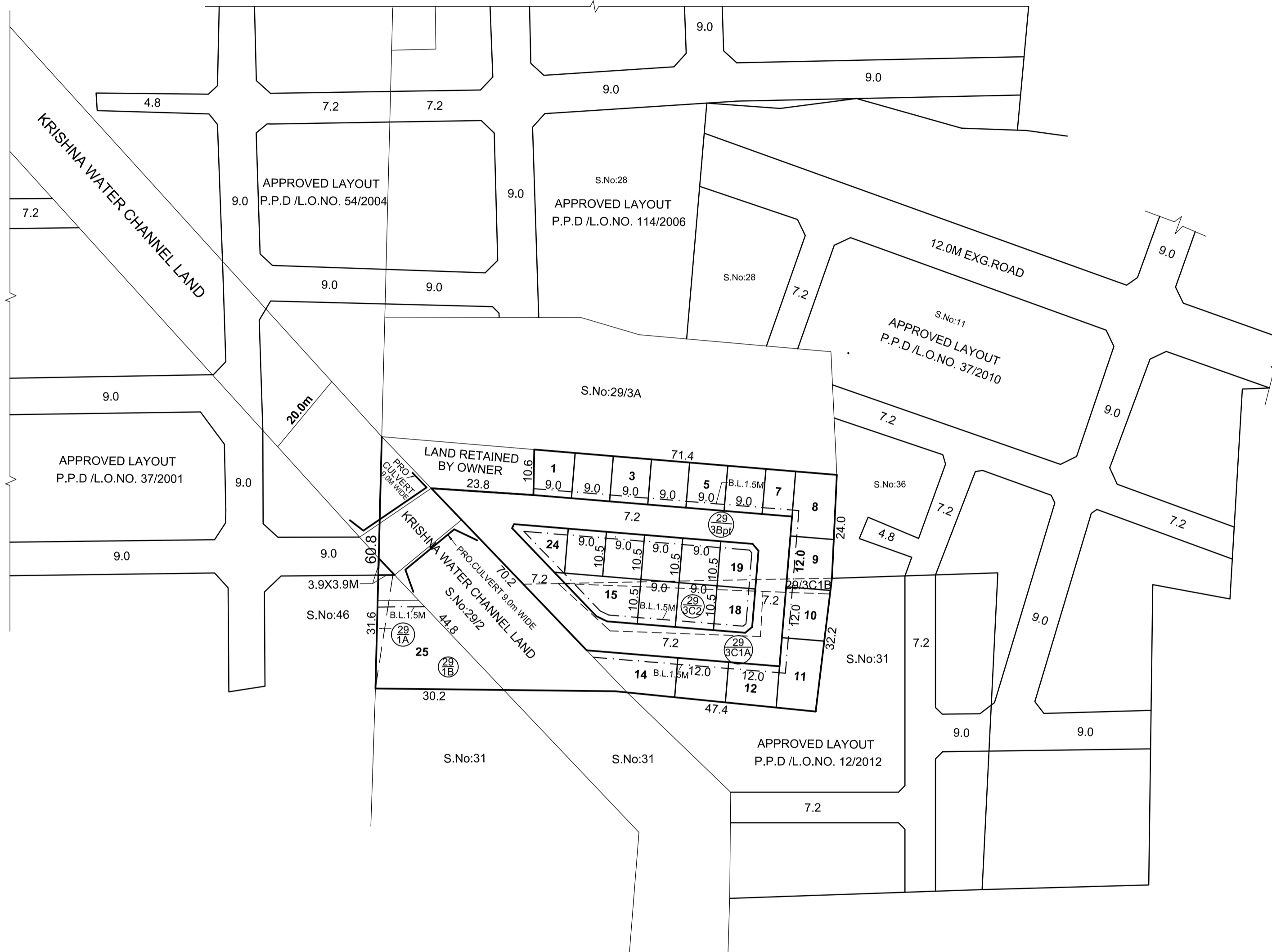

CONDITION:-
 THE LAYOUT APPROVAL IS VALID SUBJECT TO OBTAINING SANCTION FROM THE LOCAL BODY CONCERNED

P.P.D	NO	40
L.O	APPROVED	2018

VIDE LETTER NO : L1 / 15231 / 2016
DATED : 12 / 06 / 2018

OFFICE COPY
 FOR MEMBER SECRETARY
 CHENNAI METROPOLITAN
 DEVELOPMENT AUTHORITY



POONAMALLEE PANCHAYAT UNION

LAYOUT OF HOUSE SITES IN S.Nos: 29/1A, 1B, 3B PART, 3C1A, 3C1B AND S.No.29/3C2 OF GOPARASANALLUR VILLAGE.

SCALE : 1:800 (ALL MEASUREMENTS ARE IN METRE.)