

**SITE EXTENT**(LEAST EXTENT AS PER CADD) : **764 SQ.M**



**NO.OF.PLOTS** : **5 NOS**

**CONDITIONS :**

**DR RULE NO : 29 (11)**

THE COST OF LAYING IMPROVEMENTS TO THE SYSTEMS INRESPECT OF ROAD, WATER SUPPLY, SEWERAGE, DRAINAGE OR ELECTRIC POWER SUPPLY THAT MAY BE REQUIRED AS ASSESSED BY THE COMPETENT AUTHORITY SHALL BE BORNE BY THE APPLICANT.

**LEGEND :**

-  SITE BOUNDARY
-  EXISTING ROAD

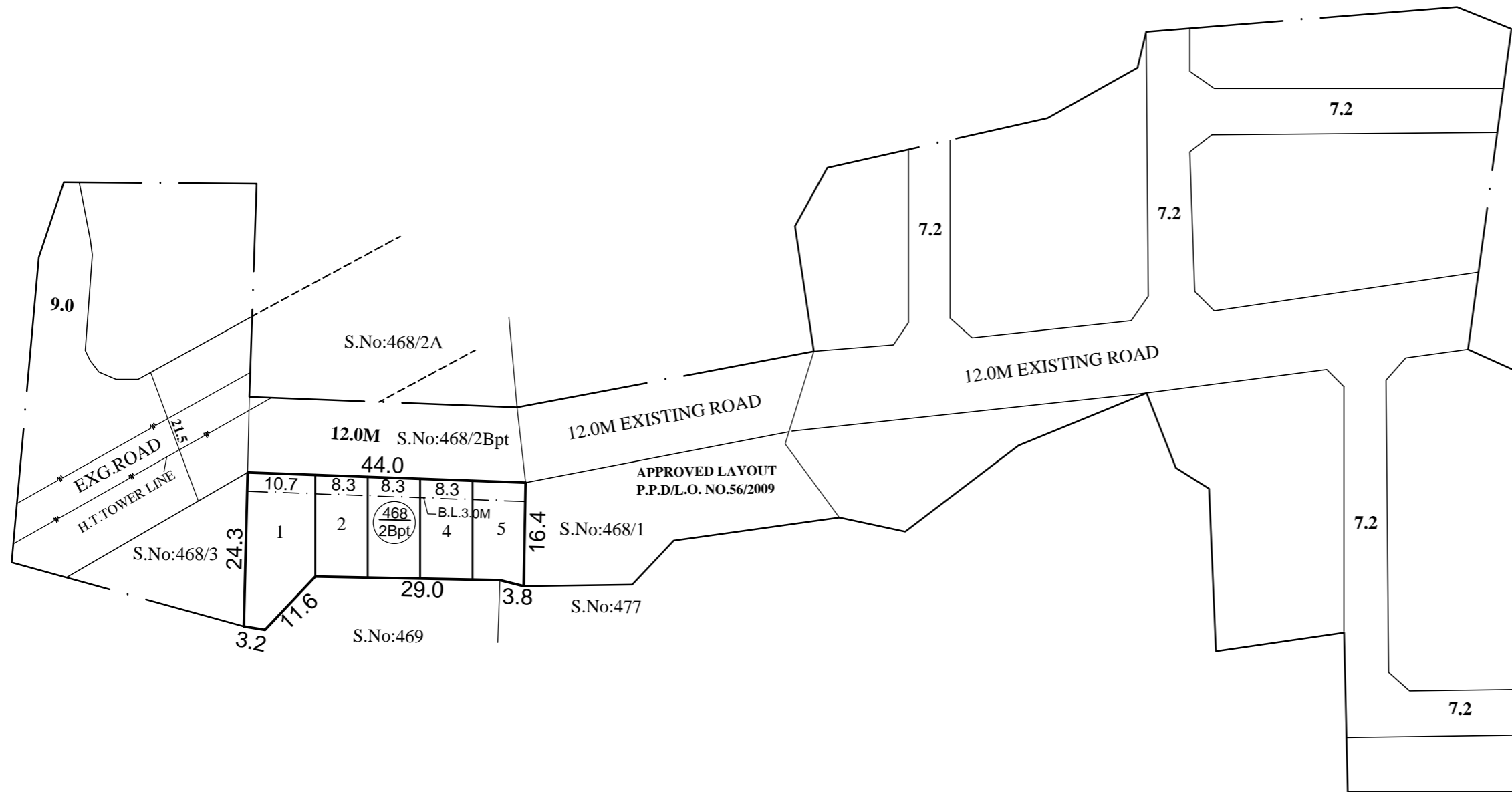

**CONDITION:-**  
THE SUB-DIVISION APPROVAL IS VALID SUBJECT TO OBTAINING SANCTION FROM THE LOCAL BODY CONCERNED

**P.P.D** NO **43**  
**L.O** **2017**  
**APPROVED**

VIDE LETTER NO : L1 / 771 / 2017  
DATED : 18 / 09 / 2017

**OFFICE COPY**

FOR MEMBER SECRETARY  
CHENNAI METROPOLITAN  
DEVELOPMENT AUTHORITY

**AVADI GREATER MUNICIPALITY**

**SUB - DIVISION OF HOUSE SITES IN S.NO.468/2Bpt OF PARUTHIPATTU VILLAGE.**

SCALE-1:800 (ALL MEASUREMENTS ARE IN METRE)

