

TOTAL EXTENT : 8498 SQ.M
ROAD AREA : 1318 SQ.M
NO. OF PLOTS : 14 NOS.

NOTE:

1. SPLAY - 1.5M x 1.5M,
2. MEASUREMENTS ARE INDICATED EXCLUDING SPLAY DIMENSIONS
3.  ROAD AREA WAS ALREADY HANDED OVER TO THE LOCAL BODY
 VIDE GIFT DEED DOCUMENT NO. 3051/2014, DATE: 28.4.2014.



DR. RULE NO. 29(11)

(I) THE COST OF LAYING IMPROVEMENTS TO THE SYSTEMS IN RESPECT OF ROAD, WATER SUPPLY, SEWERAGE, DRAINAGE OR ELECTRIC POWER SUPPLY THAT MAY BE REQUIRED AS ASSESSED BY THE COMPETENT AUTHORITY, SHALL BE BORNE BY THE APPLICANT.

(II) LETTER NO. CHEN/SOUTH/B/072013/15279 TO 15284 & 15286 TO 15288, DATED 20.7.2013, FROM AAI, CHENNAI-27.

THE NOC FOR HEIGHT RESTRICTION HOWEVER NEEDS TO BE OBTAINED FROM THE NOC CELL AAI, SOUTHERN REGION, CHENNAI AT THE TIME OF ACCORDING APPROVAL FOR THE BUILDING PLAN.

LEGEND:

-  SITE BOUNDARY
-  PROPOSED ROAD
-  EXISTING ROAD

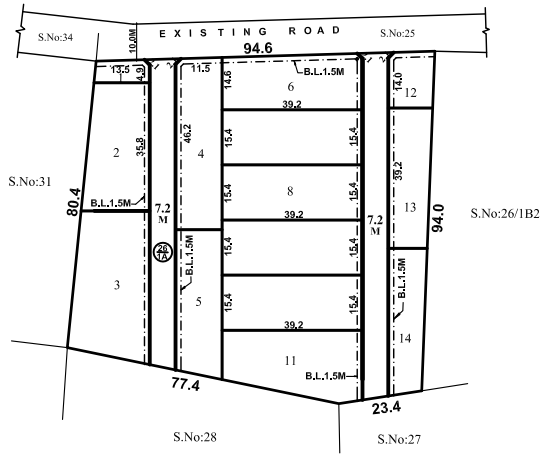

CONDITION:-
 THE SUBDIVISION APPROVAL IS VALID SUBJECT TO OBTAINING SANCTION FROM THE LOCAL BODY CONCERNED.

P.P.D	NO.	16
L.O.		2014

APPROVED

VIDE LETTER NO : L1/18242/2013
 DATE : 16 / 05 / 2014

OFFICE COPY
 FOR MEMBER SECRETARY
 CHENNAI METROPOLITAN
 DEVELOPMENT AUTHORITY

KUNDRATHUR PANCHAYAT UNION

LAYOUT OF HOUSE SITES IN S.No: 26/1A OF KOLAPAKKAM VILLAGE.

SCALE - 1:800 (ALL MEASUREMENTS ARE IN METRE)