

TOTAL EXTENT : **4600 SQ.M**
ROAD AREA : **1460 SQ.M**
TOTAL NO. OF PLOTS : **20 NOS**

NOTE:

1. SPLAY - 1.5M X 1.5M, 3.0M X 3.0M
2. MEASUREMENTS ARE INDICATED EXCLUDING SPLAY DIMENSIONS
3. ROAD AREA WAS ALREADY HANDED OVER TO THE LOCAL BODY VIDE GFT DEED DOCUMENT NO 9194 / 2013, DATED: 27/8/2013.

CONDITIONS:

THE FOLLOWING CONDITIONS OF WRD, VIDE THE CE, WRD, CHENNAI REGION, CHEMPAK, CHENNAI-5, LETTER NO:75(9)/28/4/2012, DATED 3.10.2012, ARE TO BE COMPLIED BY THE APPLICANT BEFORE ISSUING OF THE LAYOUT APPROVAL BY THE COMPETENT AUTHORITY (LOCAL BODY).

1. THE PROPOSED SITES SHOULD BE RAISED BY FILLING WITH HARD SOIL TO HEIGHT OF MINIMUM 1.44M TO 1.49M IN ORDER TO REACH THE LEVEL OF (+) 19.000M TO AVOID INUNDATION IN FUTURE.
2. THE PROCESS OF EARTH FILLING AND COMPACTION SHOULD BE DONE IN LAYERS OF NOT MORE THAN 0.30M DEPTH TO ACHIEVE REQUIRED DEGREE OF COMPACTION.
3. THE FOUNDATION FOOTINGS SHOULD BE PLACED IN THE ORIGINAL SOIL STRATA TO AVOID UNEQUAL SETTLEMENT OF THE SUPER STRUCTURE.
4. THE PROMOTERS SHOULD PROVIDE ADEQUATE STORM WATER DRAIN ARRANGEMENTS IN THE PROPOSED SITE AT THEIR OWN COST.
5. THE PROMOTERS SHOULD PROVIDE RAIN WATER HARVESTING ARRANGEMENTS IN THEIR LAND SITE AT THEIR OWN COST.
6. SEWAGE AND SULLAGE WATER SHOULD NOT BE LET IN TO THE CHANNEL, AND GOVERNMENT PROMOTEE LAND OF S.NO:217 AND NECESSARY SEWAGE TREATMENT PLANT ARRANGEMENT SHOULD BE CONSTRUCTED AS PER POLLUTION CONTROL BOARD NORMS AT THE PROPOSED SITE BY THE PROMOTERS AT THEIR OWN COST.
7. THE PROMOTERS SHOULD PROVIDE ADEQUATE DEWATERING ARRANGEMENTS TO BAL OUT THE WATER WITH IN THE PREMISES AT THEIR OWN COST.
8. ADVANCE INTIMATION SHOULD BE GIVEN TO THE WRD OFFICERS CONCERNED BEFORE THE COMMENCEMENT OF WORK.
9. THE PROMOTERS SHOULD UTILIZED THE LAND FOR CONSTRUCTION OF RESIDENTIAL BUILDING SITES ONLY, PRIOR APPROVAL OF THE WATER RESOURCES DEPARTMENT SHOULD BE OBTAINED IF THIS LAND IS TOO UTILIZED FOR ANY OTHER PURPOSE.
10. THE WRD OFFICIALS SHOULD BE ALLOWED TO INSPECT THE PROPOSED SITE AT ANY TIME DURING EXECUTION.
11. THE PROMOTERS SHOULD ABIDE BY THE RULES AND REGULATIONS OF THE WRD FROM TIME TO TIME.
12. THE PROMOTERS SHALL NOT MAKE ANY HINDERANCE TO THE FREE FLOW OF WATER THROUGH THE EXISTING CHANNEL.
13. NO ENCROACHMENT SHOULD BE DONE IN GOVERNMENT PROMOTEE LANDS / FIELD CHANNEL, AND S.NO:217) AND NECESSARY DEMARCATION SHOULD BE DONE THROUGH THE REVENUE DEPARTMENT IN THE PRESENCE OF THE WATER RESOURCES DEPARTMENT OFFICIALS.
14. FAILING TO COMPLY WITH ANY OF THE ABOVE CONDITIONS, WRD RESERVES THE RIGHTS RECOMMENDED TO THE CHENNAI METROPOLITAN DEVELOPMENT AUTHORITY TO CANCEL THE PLANNING PERMISSION AND IN THAT EVENT OF SUCH REVOCATION AND THE PROMOTERS SHALL NOT BE ELIGIBLE FOR ANY COMPENSATION WHATSOEVER.

III. DR. RULE NO. 29(11)

THE COST OF LAYING IMPROVEMENTS TO THE SYSTEMS, IN RESPECT OF ROAD, WATER SUPPLY, SEWERAGE, DRAINAGE OR ELECTRIC POWER SUPPLY THAT MAY BE REQUIRED AS ASSESSED BY THE COMPETENT AUTHORITY, SHALL BE BORNE BY THE APPLICANT.

LEGEND:

- ▬ SITE BOUNDARY
- ▬ PROPOSED ROAD
- ▬ EXISTING ROAD
- ▬ CHANNEL

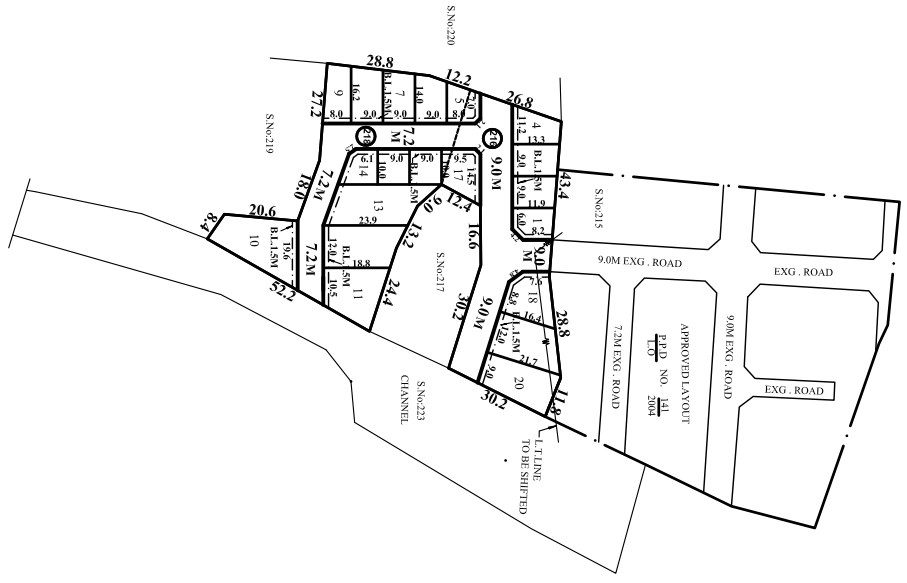

PREPARED BY: PALLIQA AP D.P.VAKA
MANGADU TOWN PANCHAYAT
LAYOUT OF HOUSE SITES IN S.No. 216, AND S.No. 218 OF MANGADU VILLAGE.
 SCALE - 1:800. (ALL MEASUREMENTS ARE IN METRE)

CONDITION:-
 THE LAYOUT APPROVAL IS VALID SUBJECT TO OBTAINING SANCTION FROM THE LOCAL BODY CONCERNED.

P.P.D. NO. 29
 L.O. 2013
 APPROVED
 VIDE LETTER NO : L/1/ 7761 / 2012
 DATE : 18 / 7 / 2013
 OFFICE COPY

FOR MEMBER SECRETARY
 CHENNAI METROPOLITAN
 DEVELOPMENT AUTHORITY

