

**TOTAL EXTENT** = 6308 Sq.M  
**ROAD AREA** = 1522 Sq.M  
**PARK AREA** = 189 Sq.M  
**TOTAL No. OF PLOTS** = 25 Nos.

**NOTE:**

1. SPLAY - 1.5M x 1.5M
2. MEASUREMENTS ARE INDICATED EXCLUDING SPLAY DIMENSIONS
3.  ROAD AREA } WERE ALREADY HANDED OVER TO THE LOCAL BODY  
 PARK AREA } VIDE GIFT DEED DOC.NO: 4404 / 2012, DATED: 16 / 08 / 2012.

**CONDITION :**

**DR RULE NO: 29 (11)**

THE COST OF LAYING IMPROVEMENTS TO THE SYSTEMS INRESPECT OF ROAD, WATER SUPPLY, SEWERAGE, DRAINAGE OR ELECTRIC POWER SUPPLY THAT MAY BE REQUIRED AS ASSESSED BY THE COMPETENT AUTHORITY, SHALL BE BORNE BY THE APPLICANT.

**LEGEND:**

- SITE BOUNDARY
- PROPOSED ROAD
- EXISTING ROAD
- PARK

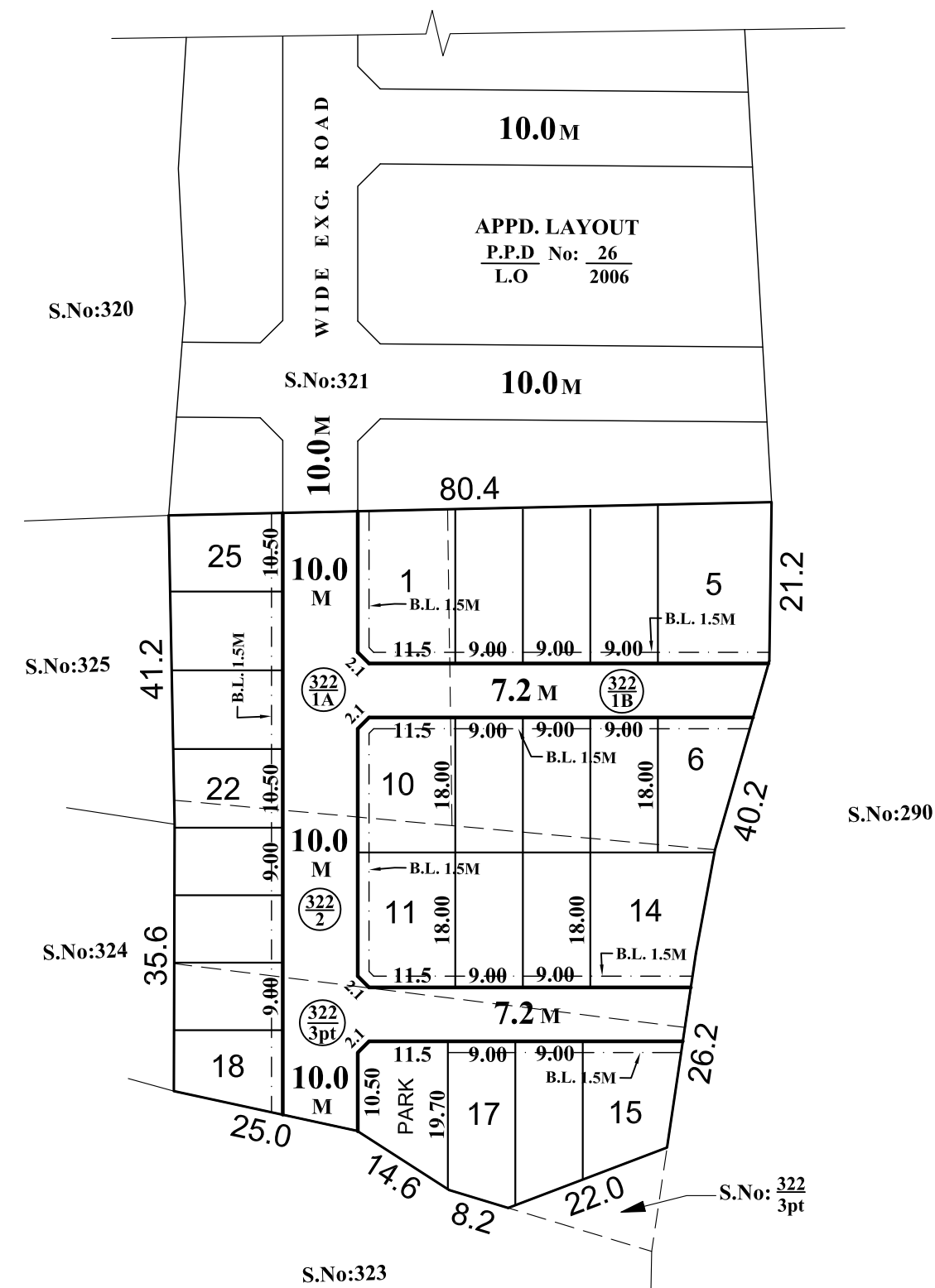

**CONDITIONS:**

THE LAYOUT APPROVED IS VALID SUBJECT TO OBTAINING SANCTION FROM THE LOCAL BODY CONCERNED.

**P.P.D** NO: 31  
**L.O** 2012

**APPROVED**

VIDE LETTER NO : L1 / 1656 / 2012

DATE : 15 / 09 / 2012

**OFFICE COPY**

FOR MEMBER SECRETARY  
 CHENNAI METROPOLITAN  
 DEVELOPMENT AUTHORITY

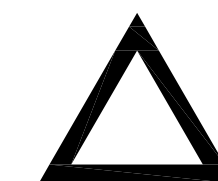

**KUNRATHUR PANCHAYAT UNION**

**LAYOUT OF HOUSE SITES IN S.Nos: 322/1A, 1B, 2 & 322/3pt OF GERUGAMBAKKAM VILLAGE.**

SCALE : 1:800 (ALL MEASUREMENTS ARE IN METRE.)