



**TOTAL EXTENT : 8250 SQ.M**  
**ROAD AREA : 1962 SQ.M**  
**PARK AREA : 660 SQ.M**  
**NO OF PLOTS : 32 NOS**

**NOTE:**

1. SPLAY - 1.5MX1.5M, 3.0M X 3.0M
2. MEASUREMENTS ARE INDICATED EXCLUDING SPLAY DIMENSIONS.
3. 

	} WERE ALREADY HANDED OVER TO THE LOCAL BODY VIDE GIFT DEED DOCUMENT NO: 131/2011, DATED:14.2.2011.
	

**CONDITIONS:-**

(I) THE FOLLOWING CONDITIONS OF PWD STIPULATED IN CHIEF ENGINEER, WRD, CHENNAI REGION, CHEPAUK, CHENNAI - 5, LETTER NO.TS(3)/23704/2010 DT.17.02.2011 ARE TO BE COMPLIED BY THE APPLICANT BEFORE ISSUING OF THE LAYOUT APPROVAL BY THE COMPETENT AUTHORITY. (LOCAL BODY)

1. IT IS RECOMMENDED TO PROVIDE INDIVIDUAL DRIVEN PILES FOR FOUNDATION, PENETRATED IN TO THE ORIGINAL SOIL STRATA, AS THE DEPTH OF FILLING REQUIRED IS MORE THAN 1.50m.
2. THE PROCESS OF EARTH FILLING AND COMPACTION SHOULD BE DONE ONLY AFTER THE ERECTION OF FOUNDATION FOOTINGS.
3. THE PROCESS OF FILLING AND COMPACTION SHOULD BE DONE IN LAYERS OF NOT MORE THAN 30CM DEPTH, TO ACHIEVE REQUIRED DEGREE OF COMPACTION.
4. THE PILES SHOULD BE WELL INTERCONNECTED WITH AN INTERMEDIATE GRADE BEAMS AT THE FINISHED GROUND LEVEL, TO MINIMIZE THE BUCKING OF COLUMNS.
5. THE EXISTING AVERAGE GROUND LEVEL OF THE SITE UNDER REFERENCE SHOULD BE RAISED TO MINIMUM LEVEL OF (+) 8.800 M (8.500M + 0.300M) UNIFORMLY, WITH AN AVERAGE FILLING, VARYING FROM 0.425M TO 2.58M, TO AVOID INUNDATION DURING HEAVY FLOODS.
6. THE APPLICANT SHOULD PROVIDE NECESSARY RAIN WATER HARVESTING ARRANGEMENTS IN THE PROPOSED SITE AT HER OWN COST.
7. THE APPLICANT SHOULD PROVIDE ADEQUATE DEWATERING ARRANGEMENTS TO BAIL OUT WATER WITHIN HER PROPERTY AND NECESSARY DRAINAGE FACILITIES MUST BE PROVIDE AT HER OWN COST.
8. THE WATER RESOURCES DEPARTMENT OFFICIALS SHOULD BE ALLOWED TO INSPECT THE SITE, AT ANY TIME, DURING EXECUTION.
9. ADVANCE INTIMATION SHOULD BE GIVEN TO THE WATER RESOURCES DEPARTMENT OFFICERS BEFORE THE COMMENCEMENT OF THE WORK.
10. THE APPLICANT SHOULD ABIDE BY THE RULES AND REGULATIONS OF THE WATER RESOURCES DEPARTMENT FROM TIME TO TIME.
11. THE WATER RESOURCES DEPARTMENT HAVE EVERY RIGHT TO ADDRESS THE CMDA, TO CANCEL THE PERMISSION GRANTED FOR THIS RECLASSIFICATION PROPOSAL, IN CASE OF BREACH OF ANY OF THE CONDITIONS AND IN THAT EVENT, THE APPLICANT SHALL NOT BE ELIGIBLE FOR ANY COMPENSATION WHATSOEVER.

(II) DR. RULE NO:29(11)

THE COST OF LAYING IMPROVEMENTS TO THE SYSTEMS IN RESPECT OF ROAD, WATER SUPPLY, SEWERAGE, DRAINAGE OR ELECTRIC POWER SUPPLY THAT MAY BE REQUIRED AS ASSESSED BY THE COMPETENT AUTHORITY SHALL BE BORNE BY THE APPLICANT.





(III) AT THE TIME OF OBTAINING PLANNING PERMISSION FOR BUILDING NOC FROM THE FOLLOWING OFFICES IN AIRPORT AUTHORITY OF INDIA TO BE OBTAINED.

1. REGIONAL EXECUTIVE DIRECTOR, SOUTHERN REGION, CHENNAI AIRPORT, CHENNAI
2. AIRPORT DIRECTOR, CHENNAI AIRPORT, CHENNAI.

(IV) LOCAL BODY SHOULD ENSURE COMPLIANCE OF ALL THE CONDITIONS STIPULATE BY PWD IN THEIR LETTER NO.TS(3) /23704/2010. DT.17.2.2011, AND SHALL OBTAIN A LETTER FROM PWD CONFIRMING THE COMPLIANCE OF THE CONDITIONS BEFORE THE SANCTION AND RELEASE OF THE LAYOUT.

(V) LAYOUT PLOTS ARE EQUATED WITH PR USE ZONE AND PP FOR THE BUILDINGS WILL BE ISSUED AS PER THE PROVISIONS OF DRS.

**LEGEND**

-  SITE BOUNDARY
-  PROPOSED ROAD
-  EXISTING ROAD
-  PARK

**CONDITION:-**  
THE LAYOUT APPROVAL IS VALID SUBJECT TO OBTAINING SANCTION FROM THE LOCAL BODY CONCERNED

**P.P.D**      **NO:**      **23**  
**L.O**                      **2011**

**APPROVED**

VIDE LETTER NO : L1/18498/2010

DATED : 22 /9/2011

**OFFICE COPY**

FOR MEMBER SECRETARY  
CHENNAI METROPOLITAN  
DEVELOPMENT AUTHORITY

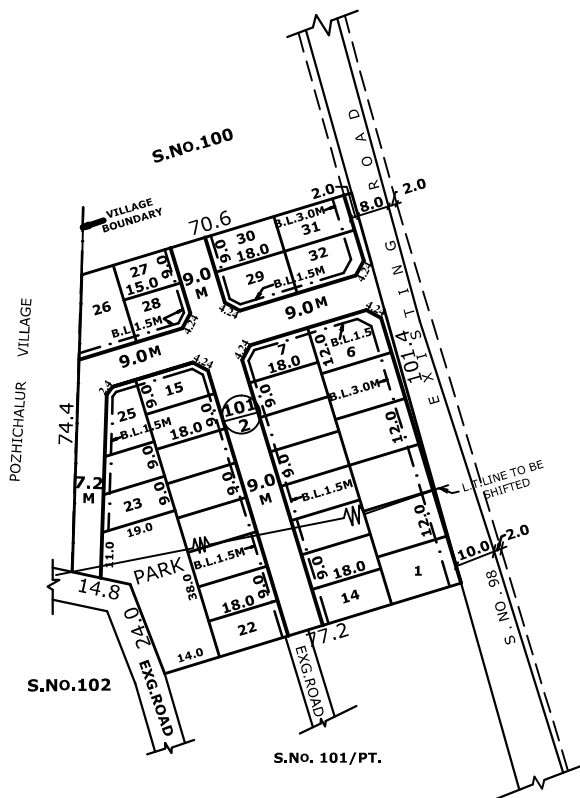

**ST.THOMAS MOUNT PANCHAYAT UNION**

**LAYOUT OF HOUSE SITES IN S.No:101/2 OF COWL BAZAAR VILLAGE**

SCALE 1: 800 (ALL MEASUREMENTS ARE IN METRE)