

S.NO:446/PT

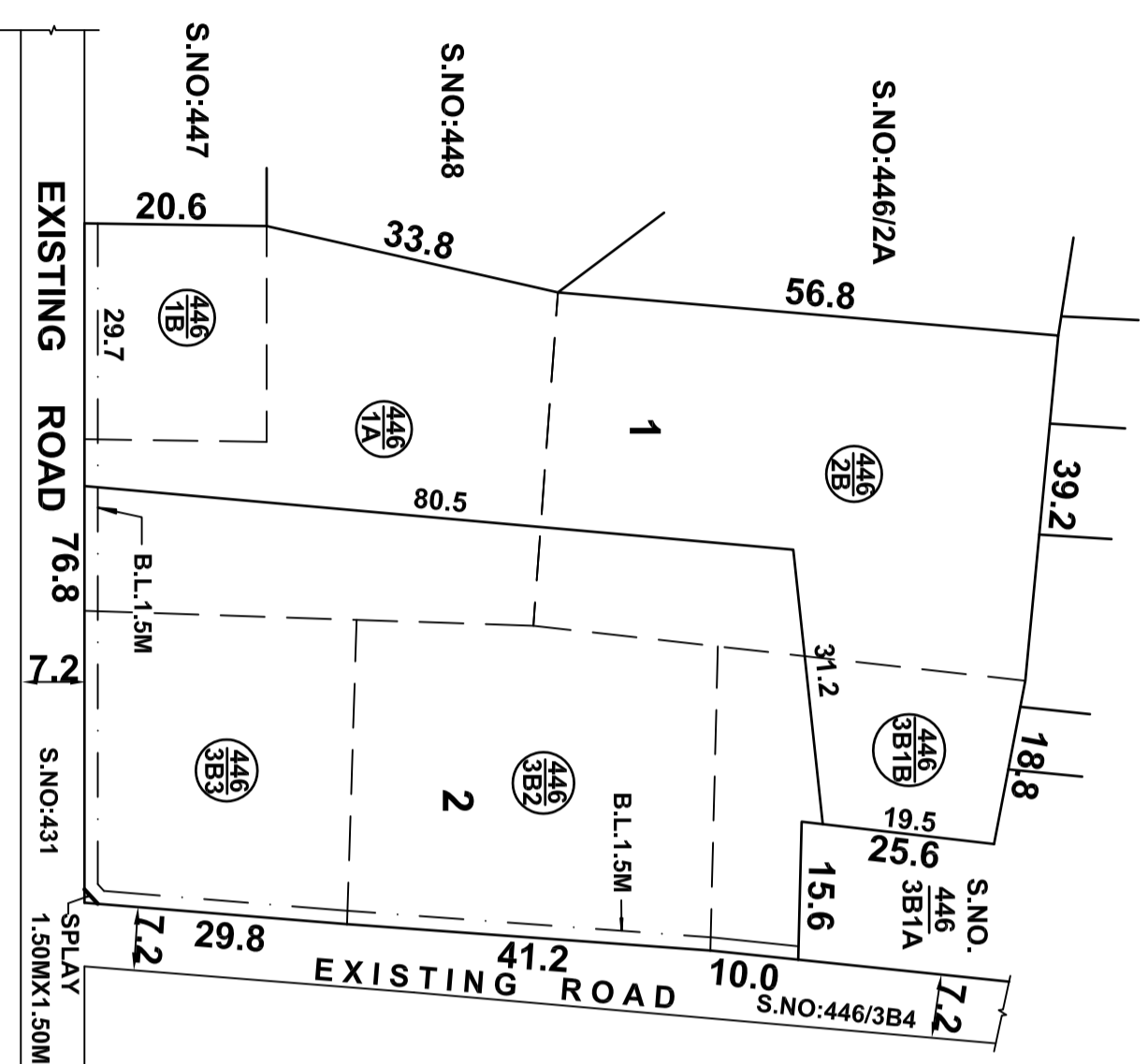

TOTAL EXTENT : 7600.000 SQ.M
SPLAY AREA : 1.125 SQ.M
TOTAL NO. OF PLOTS : 2 NOS

NOTE:

1. SPLAY - 1.5M X 1.5M
2. MEASUREMENTS INDICATED ARE EXCLUDING SPLAY DIMENSIONS.

CONDITIONS:

1. DR RULE NO: 29 (11)

THE COST OF LAYING IMPROVEMENTS TO THE SYSTEMS IN RESPECT OF ROAD, WATER SUPPLY, SEWERAGE, DRAINAGE OR ELECTRIC POWER SUPPLY THAT MAY BE REQUIRED AS ASSESSED BY THE COMPETENT AUTHORITY, SHALL BE BORNE BY THE APPLICANT.

2. THE SPLAY AREA OF 1.5M X 1.5M HAVE TO BE GIFTED TO LOCAL BODY AT THE STAGE OF OBTAINING PLANNING PERMISSION FOR BUILDING.

LEGEND:

- SITE BOUNDARY
- EXISTING ROAD
- SPLAY

CONDITIONS:
THE LAYOUT APPROVED IS VALID SUBJECT TO OBTAINING SANCTION FROM THE LOCAL BODY CONCERNED.

P.P.D NO 06
L.O APPROVED 2011
VIDE LETTER NO : L1 / 10268 / 2009
DATE : 09 / 03 / 2011

OFFICE COPY

FOR MEMBER SECRETARY
CHENNAI METROPOLITAN
DEVELOPMENT AUTHORITY

THIRUVERKADU MUNICIPALITY

SUB DIVISION OF HOUSE SITES IN S.NOS: 446/1A, 1B, 2B, 3B2, 3B3 AND 446/3B1B OF AYANAMBAKKAM VILLAGE.

SCALE :- 1:800 (ALL MEASUREMENTS ARE IN METRE.)

