

TOTAL EXTENT : 2428 M²
 ROAD AREA : 844 M²
 No. OF PLOTS : 13 Nos.

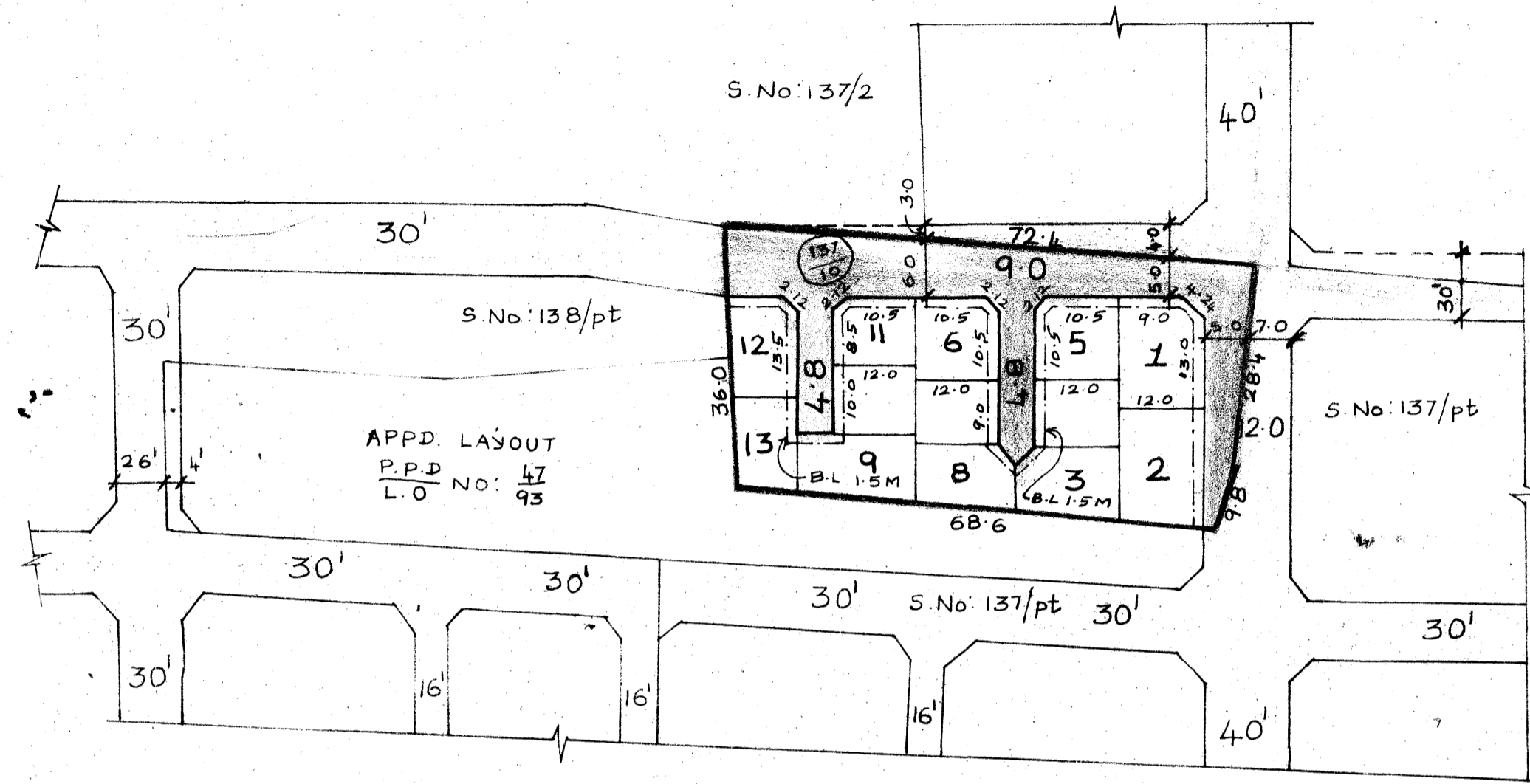

NOTE:-

1. SPLAY 1.5M X 1.5M, 3.0M X 3.0M
2. MEASUREMENTS INDICATED ARE EXCLUDING THE SPLAY DIMENSIONS.
3. ROAD AREA WAS ALREADY HANDED OVER TO THE LOCAL BODY VIDE GIFT DEED DOC NO: 5429/09 DT: 27.7.09, REVOCATION OF GIFT DEED DOC NO: 8943/09 DT: 3.12.09 AND GIFT DEED DOC NO: 8944/09 DT: 3.12.09

CONDITION:-

DR. RULE NO: 29 (ii)
 THE COST OF LAYING IMPROVEMENTS TO THE SYSTEM IN RESPECT OF ROAD, WATER SUPPLY, SEWERAGE, DRAINAGE OR ELECTRIC POWER SUPPLY THAT MAY BE REQUIRED AS ASSESSED BY THE COMPETENT AUTHORITY SHALL BE BORNE BY THE APPLICANT.

CONDITION:-
 THE LAYOUT APPROVED IS VALID SUBJECT TO OBTAINING SANCTION FROM THE LOCAL BODY CONCERNED.

LEGEND:-

- SITE BOUNDARY
- PROPOSED ROAD
- EXISTING ROAD

P.P.D NO: 25
 L.O APPROVED 2010
 VIDE LETTER NO: LI/5022/2010
 DATED : 02/08/2010

THIRUNINDRAVUR TOWN PANCHAYAT

LAYOUT OF HOUSE SITES IN S.No: 137/10 OF THIRUNINDRAVUR VILLAGE.

SCALE:- 1:800 (ALL MEASUREMENTS ARE IN METRE.)

FOR MEMBER SECRETARY
 CHENNAI METRO POLITAN
 DEVELOPMENT AUTHORITY

