

TOTAL EXTENT : 4551 M2  
 ROAD AREA : 1633 M2  
 NO.OF.PLOTS : 20 NOS





**NOTE :**

- 1.SPLAY - 3.0 MX3.0M
- 2.MEASUREMENTS ARE INDICATED EXCLUDING SPLAY DIMENSIONS
3. ROAD AREA WAS ALREADY HANDED OVER TO THE LOCAL BODY  
 VIDE GIFT DEED DOCUMENT NO.633 /2010 DATED: 22 / 1 / 2010

**CONDITION:-**

- 1.DR. RULE NO:29(11)  
 THE COST OF LAYING IMPROVEMENTS TO THE SYSTEMS IN RESPECT OF ROAD,WATER SUPPLY, SEWERAGE, DRAINAGE OR ELECTRIC POWER SUPPLY THAT MAY BE REQUIRED AS ASSESSED BY THE COMPETENT AUTHORITY SHALL BE BORNE BY THE APPLICANT.
- 2.NOC FROM AIRPORT AUTHORITY OF INDIA TO BE OBTAINED AT THE TIME OF OBTAINING PLANNING PERMISSION FOR BUILDING.

**LEGEND**

-  SITE BOUNDARY
-  PROPOSED ROAD
-  EXISTING ROAD
-  CHANNEL

**CONDITION:-**

THE LAYOUT APPROVAL IS VALID SUBJECT TO OBTAINING SANCTION FROM THE LOCAL BODY CONCERNED

**P.P.D NO 10**  
**L.O 2010**

VIDE LETTER NO : L1 / 2438 / 10  
 DATED : 8 / 03 / 10

FOR MEMBER SECRETARY  
 CHENNAI METROPOLITAN  
 DEVELOPMENT AUTHORITY

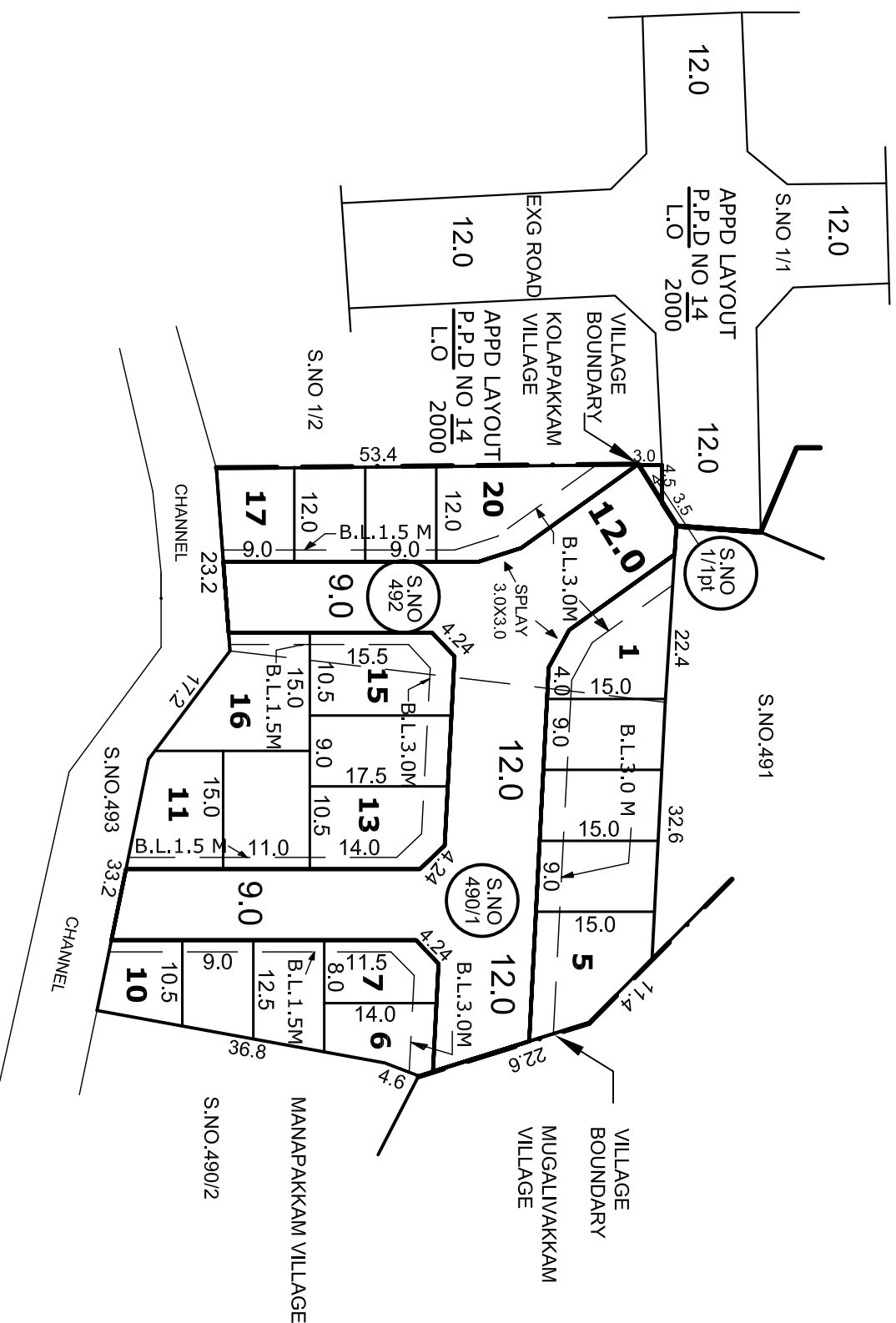

# KUNDRATHUR PANCHAYAT UNION

LAYOUT OF HOUSE SITES IN S.NO: 490/1 AND 492 OF MANAPAKKAM VILLAGE AND S.NO:1/1 Pt OF KOLAPAKKAM VILLAGE

SCALE 1 : 800 (ALL MEASUREMENTS ARE IN METRE)