

TOTAL EXTENT 600 M²
NO. OF PLOTS 4 Nos

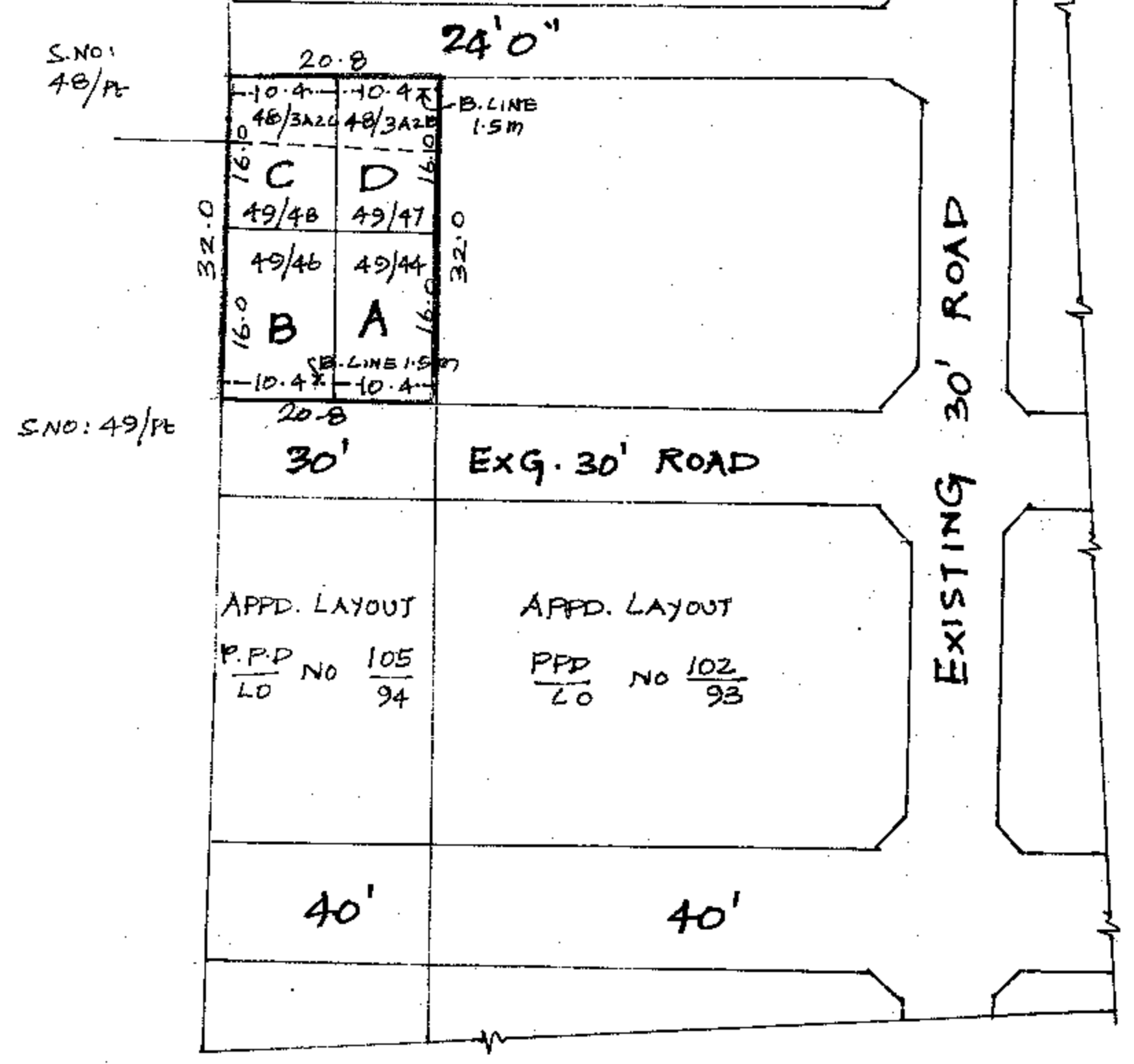

LEGEND
 [Symbol] SITE BOUNDARY
 [Symbol] EXISTING ROAD

CONDITION
 THE LAYOUT APPROVAL IS VALID
 SUBJECT TO OBTAINING SANCTION
 FROM THE LOCALBODY
 CONCERNED.

PPD NO 45
 LO NO 2009
APPROVED
 VIDE LETTER NO : LI/10933/09
 DATED : 9.10.2009

FOR OFFICE COPY

FOR MEMBER SECRETARY
 CHENNAI METROPOLITAN
 DEVELOPMENT AUTHORITY.



POONAMALLEE PANCHAYAT UNION
 AMALGAMATION OF SHOP SITE IN APPROVED LAYOUT PPD/LO NO 102/93 AND
 RESIDENTIAL PLOT NO:1, & 9 IN APPROVED LAYOUT PPD/LO NO 105/94 INTO RESIDENTIAL PLOTS
 IN S.NO: 48/3A2B, 3A2C, 49/44, 46, 47 AND 49/48, OF SENNERKUPPAM VILLAGE.
 SCALE : 1:800 (ALL MEASUREMENTS ARE IN METRES)