

TOTAL EXTENT (8.03 AC) : 32496 M²
 ROAD AREA : 9427 M²
 PARK AREA : 2472 M²
 PUBLIC PURPOSE PLOTS (I to XIV) : 2520 M²
 TOTAL NO. OF PLOTS : 102 NOS.
 NO. OF REGULAR PLOTS (1 TO 68) : 68 NOS.
 E.W.S. PLOTS (69 TO 102) (2540 M²) : 34 NOS.
 CONVENIENCE SHOP SITE (C-S) : 2 NO.
 SHOP SITE : 1 NO.

NOTE :

1. SPLAY - 3.0 M X 3.0 M.
2. MEASUREMENTS INDICATED ARE EXCLUDING THE SPLAY DIMENSIONS.
3. ROAD AREA } WERE ALREADY HANDED OVER TO THE LOCAL BODY
 PARK AREA } VIDE GIFT DEED DOC. NO. 11203/08, DATED. 30.10.2008, AND
 RECTIFICATION DEED DOC. NO. 125/2009, DATED. 12.1.2009.

CONDITION :

- I. THE AREA EARMARKED FOR PUBLIC PURPOSE I TO XIV PLOTS (VIZ. POST AND TELEGRAPH OFFICE, POLICE STATION ETC) WOULD REMAIN RESERVED FOR A SPECIFIC PERIOD OF ONE YEAR FROM THE DATE OF APPROVAL TO ENABLE THE GOVERNMENT DEPT. CONCERNED TO NEGOTIATE WITH THE OWNER AND ACQUIRE THE RESERVED LAND IF REQUIRED FOR THEM AFTER THE SAID PERIOD OF ONE YEAR AND IF NONE OF THE AGENCIES PURCHASE THE RESERVED LAND FULL/PART, THE LAYOUT OWNER/DEVELOPER IS FREE TO DISPOSE OF THE SITE RESERVED FOR PUBLIC PURPOSE TO ANYBODY FOR RESIDENTIAL USE ONLY.
- II. THE FOLLOWING CONDITIONS OF P.W.D VIDE THE CE, P.W.D, WRO, CHENNAI REGION, LETTER NO. TBC3/4829/2007/DC-24/12-2007 ARE TO BE COMPLIED BY THE APPLICANT BEFORE FORMATION OF THE LAYOUT.
 1. THE SITE HAS TO BE RAISED FOR VARYING HEIGHT OF 0.68 M TO 1.14 M ACCORDING TO THE SITE CONDITIONS.
 2. THE WIDTH OF THE CHANNEL NOTED IN THE SKETCH SHOULD BE MAINTAINED AS PER THE REVENUE RECORDS.
 3. THERE SHOULD NOT BE ANY OBSTRUCTIONS FOR THE FREE FLOW OF WATER THROUGH THE CHANNEL. THE WASTAGE FROM THE RESIDENCE SHOULD NOT BE LET IN TO THE CHANNEL. THE DRAINAGE WATER SHOULD NOT BE LET IN TO THE CHANNEL.
 4. THE PROMOTER SHOULD NOT CARRYOUT ANY OTHER CROSS MASONRY WORKS ACROSS THE CHANNEL WITHOUT PRIOR PERMISSION FROM THE PUBLIC WORKS DEPARTMENT EXCEPT THE PERMITTED NUMBER OF CULVERTS REQUESTED BY THE PROMOTER. THERE SHOULD NOT BE ANY ENROACHMENTS IN THE FIELD CHANNELS.
 5. THE PROMOTER SHOULD CONSTRUCT THE RCC BOX TYPE CULVERTS AT THEIR OWN COST AND HE IS SOLELY RESPONSIBLE FOR THE STRUCTURAL SAFETY AND STABILITY OF THE PROPOSED CULVERTS.
 6. THE PROPOSED CULVERTS SHOULD BE CONSTRUCTED AFTER GETTING APPROVAL OF THE DESIGN AND DRAWINGS BY THE EXECUTIVE ENGINEER, P.W.D, WRO KOSATHALAYAR BASIN DIVISION, THIRUVALLUR.
 7. THE PUBLIC WORKS DEPARTMENT OFFICAL SHOULD BE ALLOWED TO INSPECT THE SITE DURING EXECUTION AND THE PROMOTER SHOULD ABIDE FOR RULES AND REGULATIONS OF PUBLIC WORKS DEPARTMENT ISSUED FROM TIME TO TIME.
 8. FAILURE TO COMPLY ANY OF THE ABOVE CONDITIONS THE NOC ISSUED IS LIABLE TO BE REVOKED AT ANY TIME AND UNDER SUCH REVOCATION THE PROMOTER SHALL NOT BE ELIGIBLE FOR ANY COMPENSATION WHAT SO EVER.

LEGEND.

- SITE BOUNDARY
- ▬ PROPOSED ROAD.
- ▬ EXISTING ROAD.
- PARK.
- PUBLIC PURPOSE
- ▬ E.W.S.
- ▬ CHANNEL.
- CONVENIENCE SHOP.

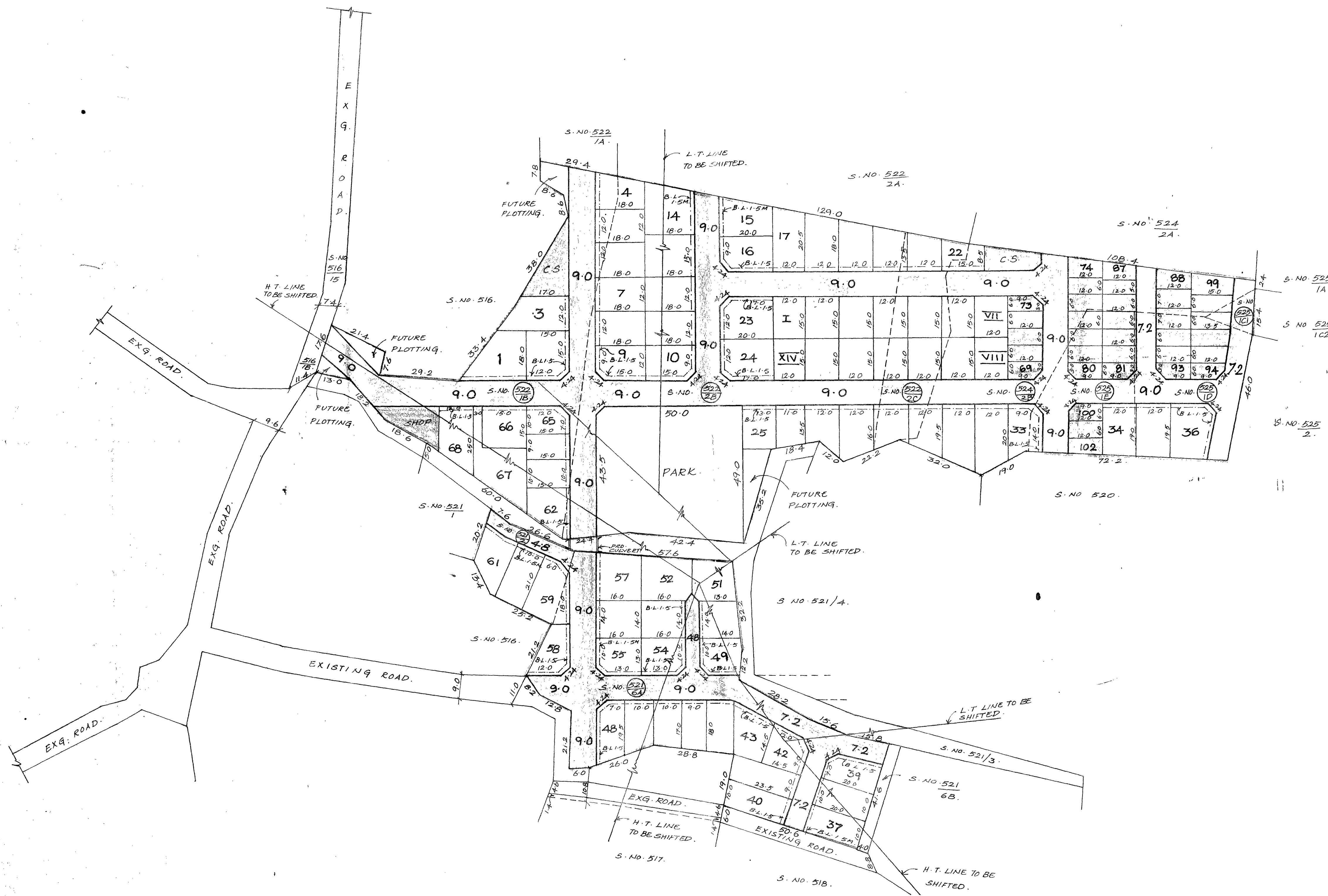

POONAMALLEE PANCHAYAT UNION.

LAYOUT OF HOUSE SITES IN S.NO.521/2, 521/6A, 522/1B, 2B, 2C, 524/2B, 525/1C1, 1D, 1E OF THIRUNINRAVUR VILLAGE.

SCALE - 1 : 800. (ALL MEASUREMENTS ARE IN METRE)

P.P.D NO. 8
 L.O APPROVED. IC
 VIDE LETTER NO : L1/21025/08.
 DATED : 12/02/2009.
 OFFICE COPY
 FOR MEMBER - SECRETARY
 CHENNAI METROPOLITAN
 DEVELOPMENT AUTHORITY

