

TOTAL EXTENT : 4550 M<sup>2</sup>  
 ROAD AREA : 1297 M<sup>2</sup>  
 NO. OF PLOTS : 20 NOS.

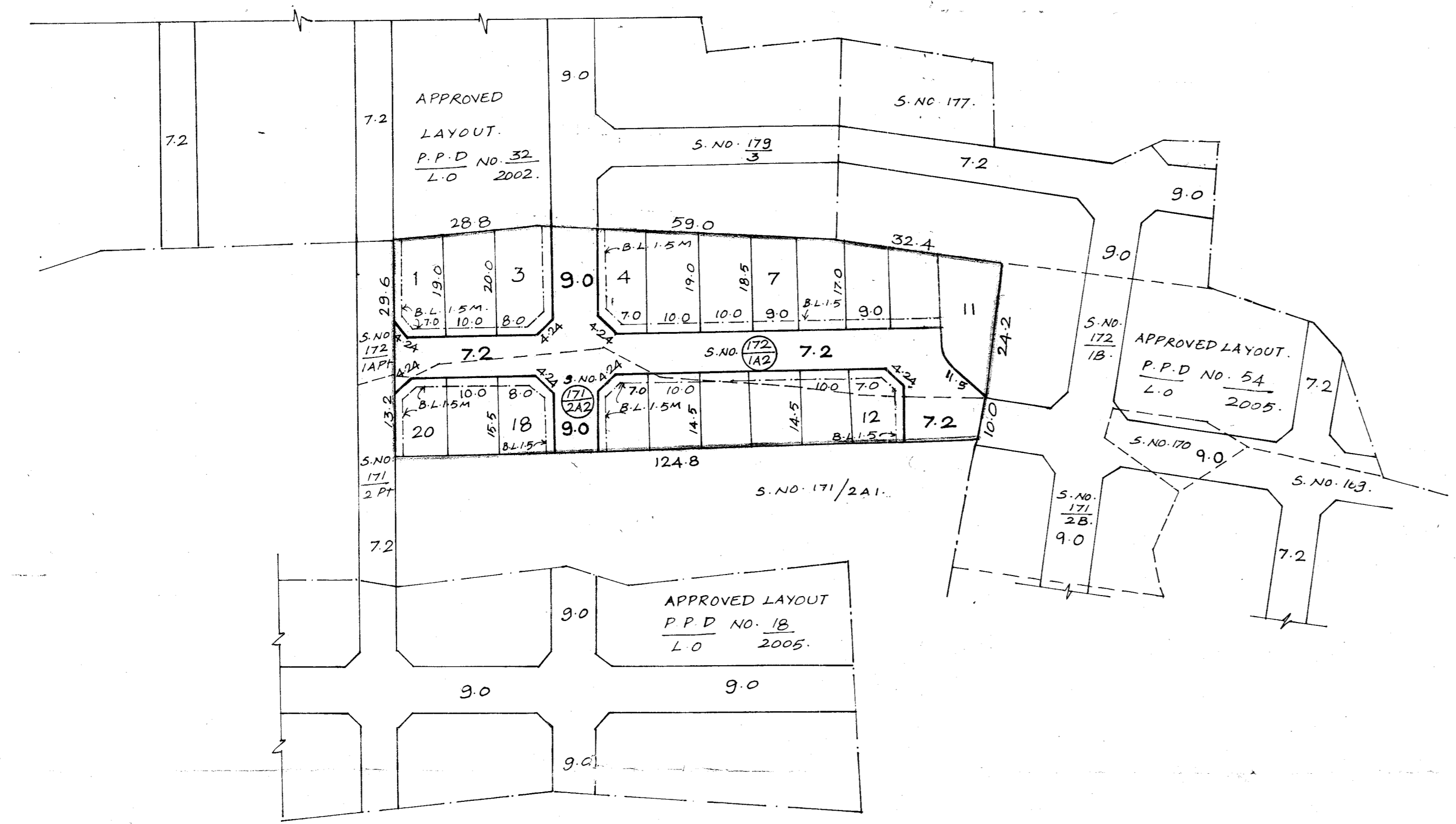

NOTE :  
 1. SPLAY. 3.0 M x 3.0 M  
 2. MEASUREMENTS INDICATED ARE EXCLUDING THE SPLAY DIMENSIONS.  
 3. ROAD AREA WAS ALREADY HANDED OVER TO THE LOCAL BODY VIDE GIFT DEED DOCUMENT NO: 5986/2008. DATED: 26.6.2008.

LEGEND :  
 SITE BOUNDARY  
 PROPOSED ROAD.  
 EXISTING ROAD.

KUNDRATHUR TOWN PANCHAYAT.  
 LAYOUT OF HOUSESITES IN S.NO. 171/2A2 AND 172/1A2 OF KUNDRATHUR VILLAGE.

SCALE - 1:800. (ALL DIMENSIONS ARE IN METRE)

P.P.D NO. 21 I.C  
 L.O 2008.  
 APPROVED.  
 VIDE LETTER NO: LI/3398/08.  
 DATED : 10/07/2008.  
**OFFICE COPY**

FOR MEMBER SECRETARY  
 CHENNAI METROPOLITAN  
 DEVELOPMENT AUTHORITY.