

TOTAL EXTENT	:	10988 M <sup>2</sup>
ROAD AREA	:	3469 M <sup>2</sup>
PARK AREA	:	797 M <sup>2</sup>
PUBLIC PURPOSE PLOTS (I to V)	:	841 M <sup>2</sup>
REGULAR PLOTS (1 to 36 x 48)	:	37 NOS.
EWS PLOTS (37 to 47)	:	11 NOS (801 M <sup>2</sup> )
NO. OF PLOTS	:	48 NOS.
SHOP SITE	:	1 NO
CONVENIENCE SHOP SITE	:	2 NOS.

**NOTE**

1. SPLAY 3.0M X 3.0M
2. MEASUREMENTS INDICATED ARE EXCLUDING THE SPLAY DIMENSIONS.
3. ROAD } AREA ALREADY HANDED OVER TO THE LOCAL BODY VIDE  
 PARK } GIFT DEED DOC. NO. 1345/2007, DT. 12.2.2007.

**CONDITION**

THE FOLLOWING CONDITION OF PWD STIPULATED IN THE CHIEF ENGINEER, PWD, WRO, CHENNAI REGION, CHENNAI-5, LR. NO. T5 (3)/17711/2005, DT. 27.6.2006, IS TO BE COMPLIED BY THE APPLICANT WHILE FORMATION OF THE LAYOUT.

A CHANNEL OF SECTION 'M X M' SHOULD BE FORMED IN THE EASTERN SIDE OF APPLICANT'S SITE BY THE APPLICANT TO DISPOSE THE DRAINAGE WATER FROM UPPER AYACUT LAND TO THE NEARBY EXISTING ROAD CULVERT.

THE AREA earmarked for PUBLIC PURPOSE (VIZ POST AND TELEGRAPH OFFICE, POLICE STATION ETC.) WOULD REMAIN RESERVED FOR A SPECIFIC PERIOD OF ONE YEAR FROM THE DATE OF APPROVAL TO ENABLE THE GOVERNMENT DEPARTMENT CONCERNED TO NEGOTIATE WITH THE OWNER AND ACQUIRE THE RESERVED LAND IF REQUIRED FOR THEM AFTER THE SAID PERIOD OF ONE YEAR, AND IF NONE OF THE AGENCIES PURCHASE THE RESERVED LAND FULL/PART, THE LAYOUT OWNER/DEVELOPER IS FREE TO DISPOSE OF THE SITE RESERVED PUBLIC PURPOSE TO ANYBODY FOR RESIDENTIAL USE ONLY.

**LEGEND**

- [---] SITE BOUNDARY
- [---] PROPOSED ROAD
- [---] EXISTING ROAD
- [---] PARK
- [---] PUBLIC PURPOSE
- [---] EWS
- [---] COMMERCIAL.

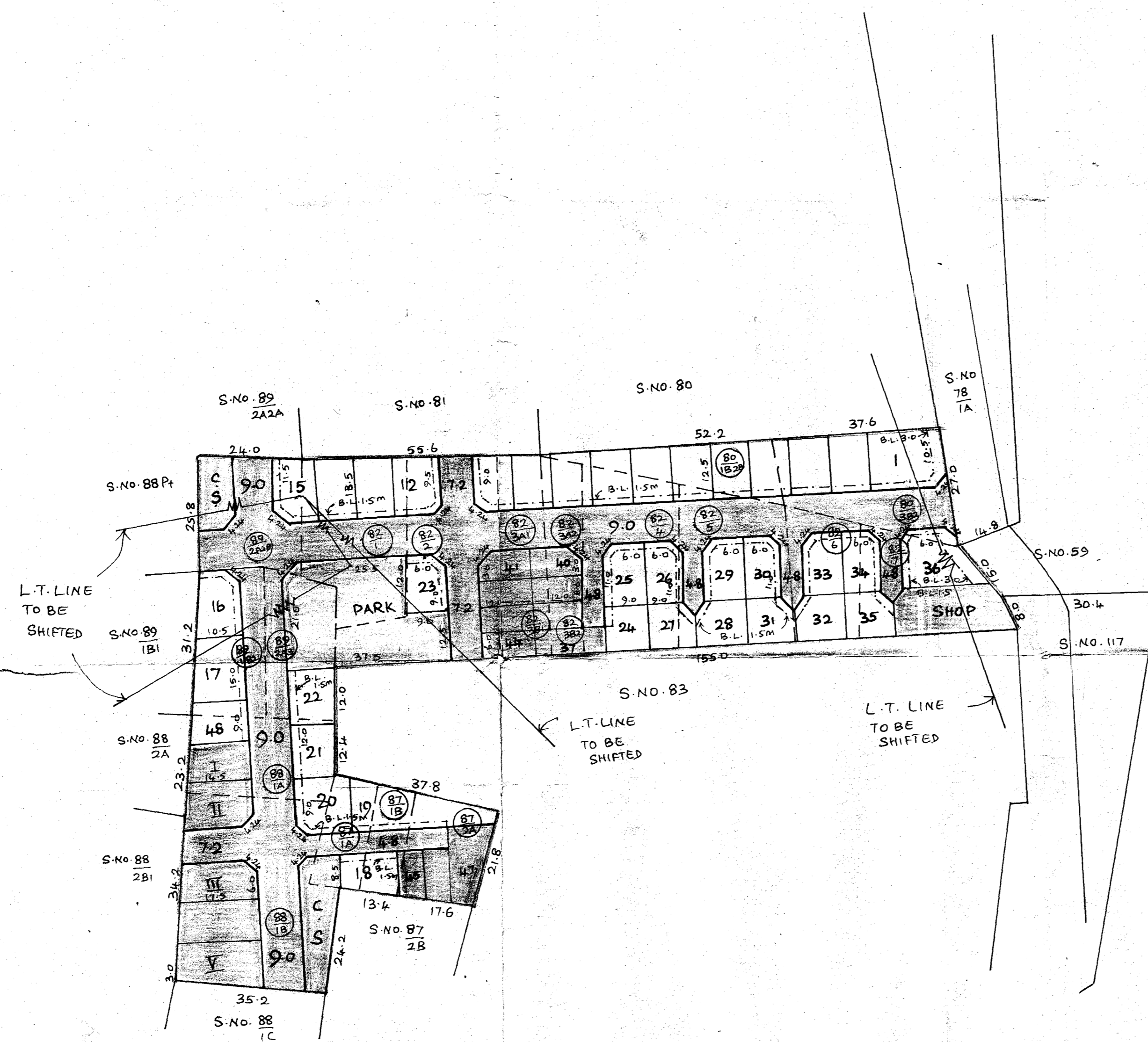

P.P.D. No. 50 I.C.  
 L.O. 2007  
**APPROVED**  
 VIDE LETTER NO. L/13632/07  
 DATED 21/9/07  
 THIS REVISES THE EARLIER APPROVED LAYOUT  
 NO. PPD. No. 21 VIDE LR. NO. L/4530/07, DT. 29.3.07

**OFFICE COPY**

FOR MEMBER SECRETARY  
 CHENNAI METROPOLITAN  
 DEVELOPMENT AUTHORITY

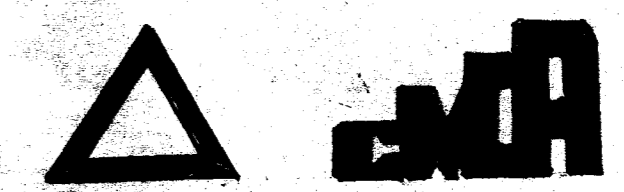

**ST. THOMAS MOUNT PANCHAYAT UNION**

LAYOUT OF HOUSE SITES IN S. NO. 80/1B2B, 3B2, 82/1, 2, 3A1, 3A2, 3B1, 3B2, 4, 5, 6, 7, 87/1A, 1B, 2A, 88/1A, 1B, 89/1B2, 2A2B AND 89/2A3 OF VENGAIVASAL VILLAGE. THIS REVISES THE EARLIER APPROVED LAYOUT NO. PPD. NO. 27/LO 2007

SCALE: 1:800 (ALL MEASUREMENTS ARE IN METRE)