

TOTAL EXTENT [7.44AC]	30108 M ²
ROAD AREA	8610 M ²
PARK AREA	2319 M ²
PUBLIC PURPOSE I TO XVIII	2352 M ²
NO. OF PLOTS	131
REGULAR PLOTS 1 TO 101	101
E.W.S. PLOTS 102 TO 131	30
C.S. CONVENIENT SHOP SITE	1

NOTE :

1. SPLAY 3.0M X 3.0M
2. MEASUREMENTS INDICATED ARE EXCLUDING SPLAY DIMENSIONS.
3. ROAD AREA WAS ALREADY HANDED OVER TO THE LOCAL BODY
PARK VIDE GIFTDEED POC NO: 3581/2006 dt 17.5.2006.

CONDITION :

THE AREA EARMARKED FOR PUBLIC PURPOSE I TO XVIII (UID. POST AND TELEGRAPH OFFICE, POLICE STATION E.T.C.) WOULD REMAIN RESERVED FOR A SPECIFIC PERIOD OF ONE YEAR FROM THE DATE OF APPROVAL TO ENABLE THE GOVT. DEPT. CONCERNED TO NEGOTIATE WITH THE OWNER AND ACQUIRE THE RESERVED LAND IF REQUIRED FOR THEM AFTER THE SAID PERIOD OF ONE YEAR AND NONE OF THE AGENCIES PURCHASE THE RESERVED LAND FULL/PART THE LAYOUT OWNER/DEVELOPER IS FREE TO DISPOSE OF THE SITE RESERVED FOR PUBLIC PURPOSE TO ANYBODY FOR RESIDENTIAL USE ONLY.

LEGEND :

- SITE BOUNDARY
- EXISTING ROAD
- PROPOSED ROAD
- PARK
- PUBLIC PURPOSE
- E.W.S.
- COMMERCIAL

PPD NO 66
LO NO 2006
APPROVED
VIDE LETTER NO: L1/10940/2006
DATED 21.6.2006

FOR MEMBER SECRETARY
CHENNAI METROPOLITAN
DEVELOPMENT AUTHORITY.

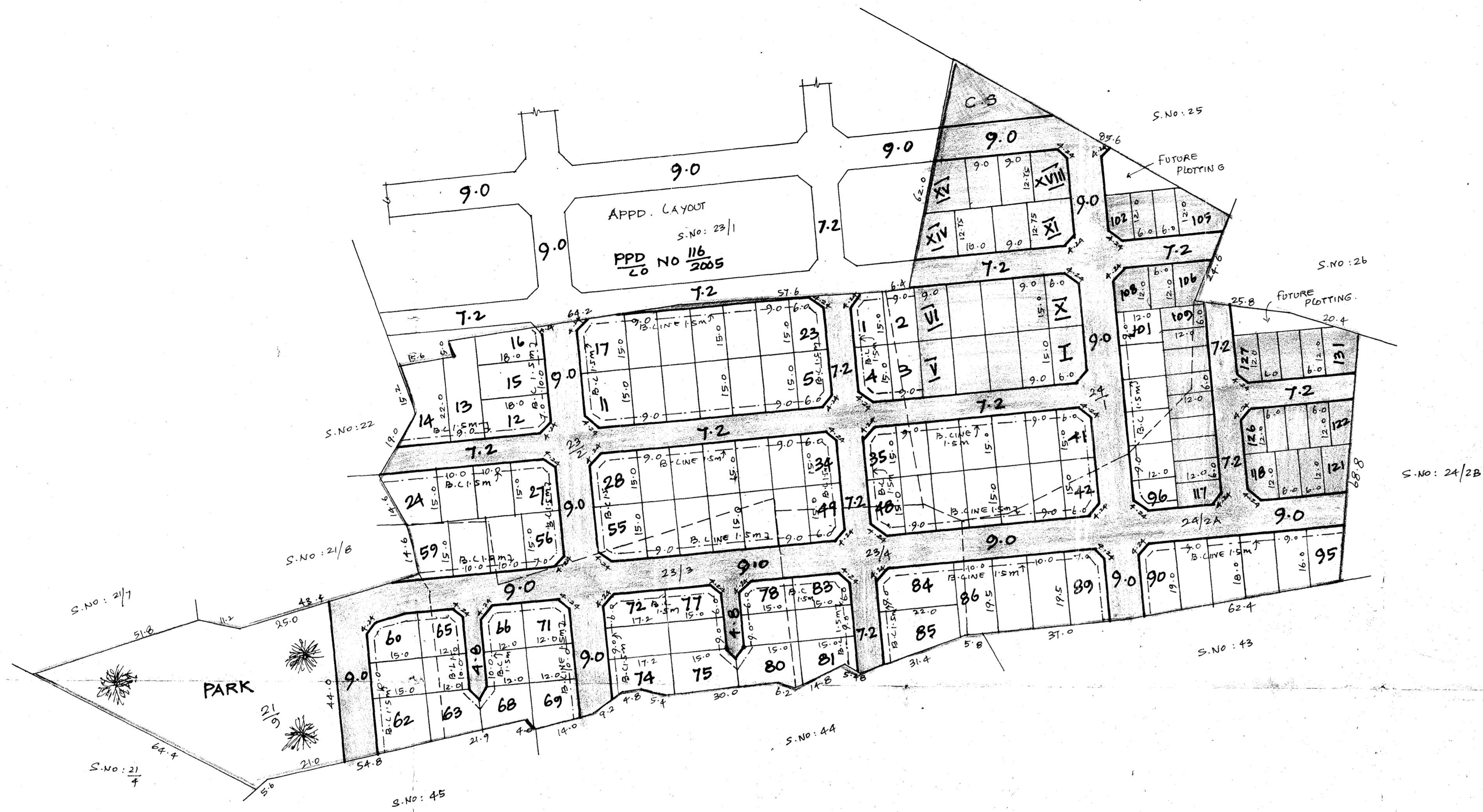
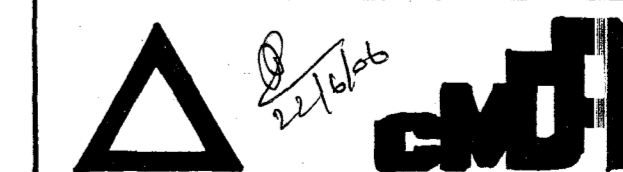

SHOLAVARAM PANCHAYAT UNION
LAY OUT OF HOUSE SITES IN S.NO: 21/9, 23/2,3,4 & 24/1,2A OF
PANNIVAKKAM VILLAGE.
SCALE : 1:800