

98

TOTAL EXTENT : 1338 M²
NO. OF PLOTS PLOT NO. AT OF: 6 NOS.

LEGEND

-  SITE BOUNDARY
-  EXISTING ROAD

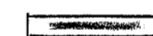
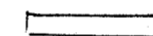
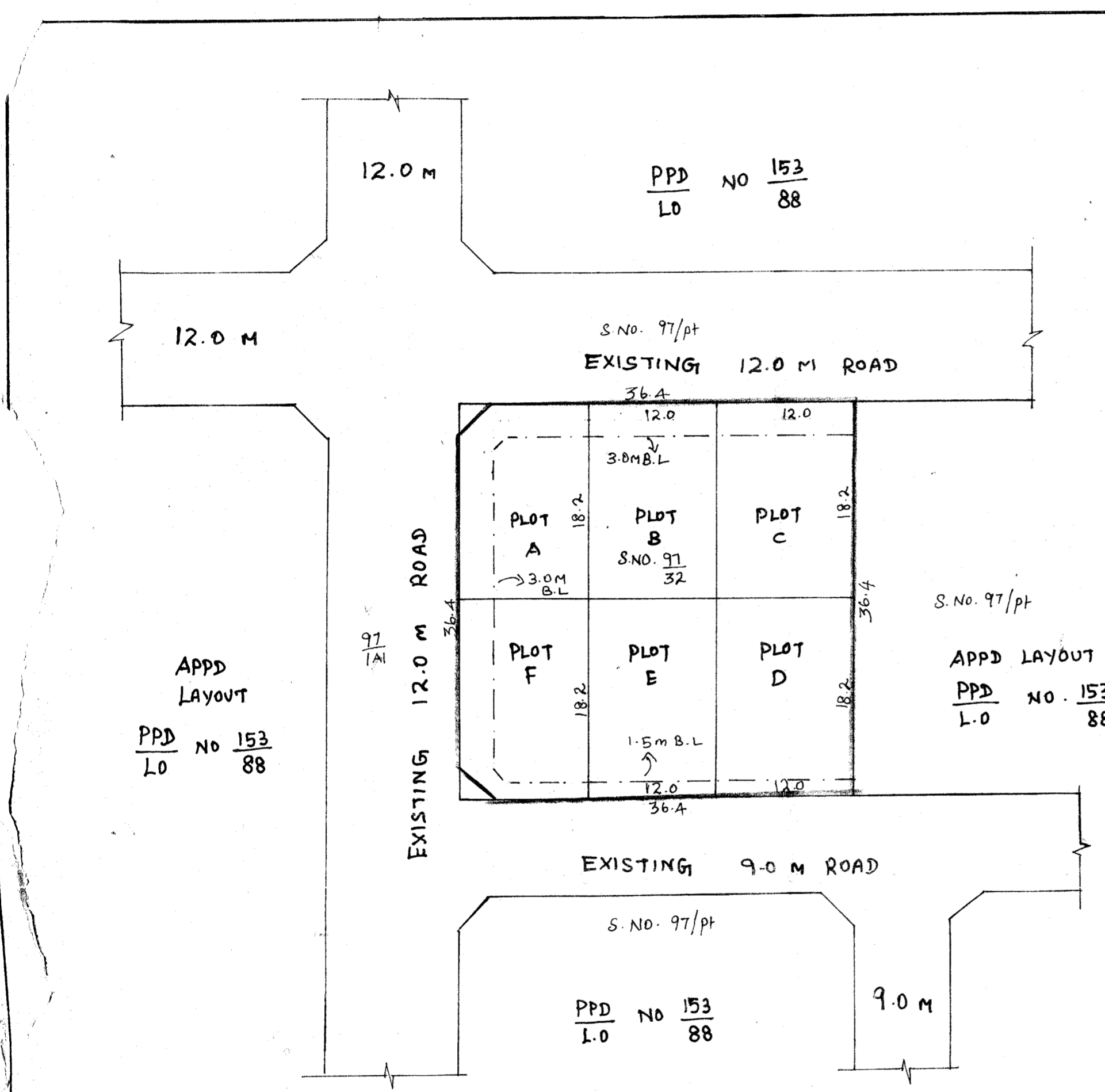

PPD NO. 98
L.O. 2005

APPROVED

VIDE LETTER NO : LI/13577/05
DATED : 25/10/05

OFFICE COPY

FOR MEMBER - SECRETARY
CHENNAI METROPOLITAN
DEVELOPMENT AUTHORITY

POONAMALLEE PANCHAYAT UNION
DERESERVATION OF SCHOOL SITE IN AN APPROVED LAYOUT OF PPD NO. 153/88
INTO RESIDENTIAL PLOTS IN S.NO. 97/32 OF KATTUPAKKAM VILLAGE

SCALE : 1 : 400

