

64

TOTAL EXTENT : 4330 M<sup>2</sup>  
ROAD AREA : 1317 M<sup>2</sup>  
PARK AREA : 109 M<sup>2</sup>  
NO OF PLOTS : 16 (1 TO 16)

**NOTE :-**

1. SPLAY 3.0M X 3.0M
2. MEASUREMENTS INDICATED ARE EXCLUDING SPLAY DIMENSION
3. ROAD AREA } WERE ALREADY HANDED OVER  
PARK AREA } TO THE LOCAL BODY VIDE GIFT  
DEED DOCUMENT NO. 3669/2005, Dt. 28.6.2005

**LEGEND :-**

- SITE BOUNDARY
- EXISTING ROAD
- PROPOSED ROAD
- PARK

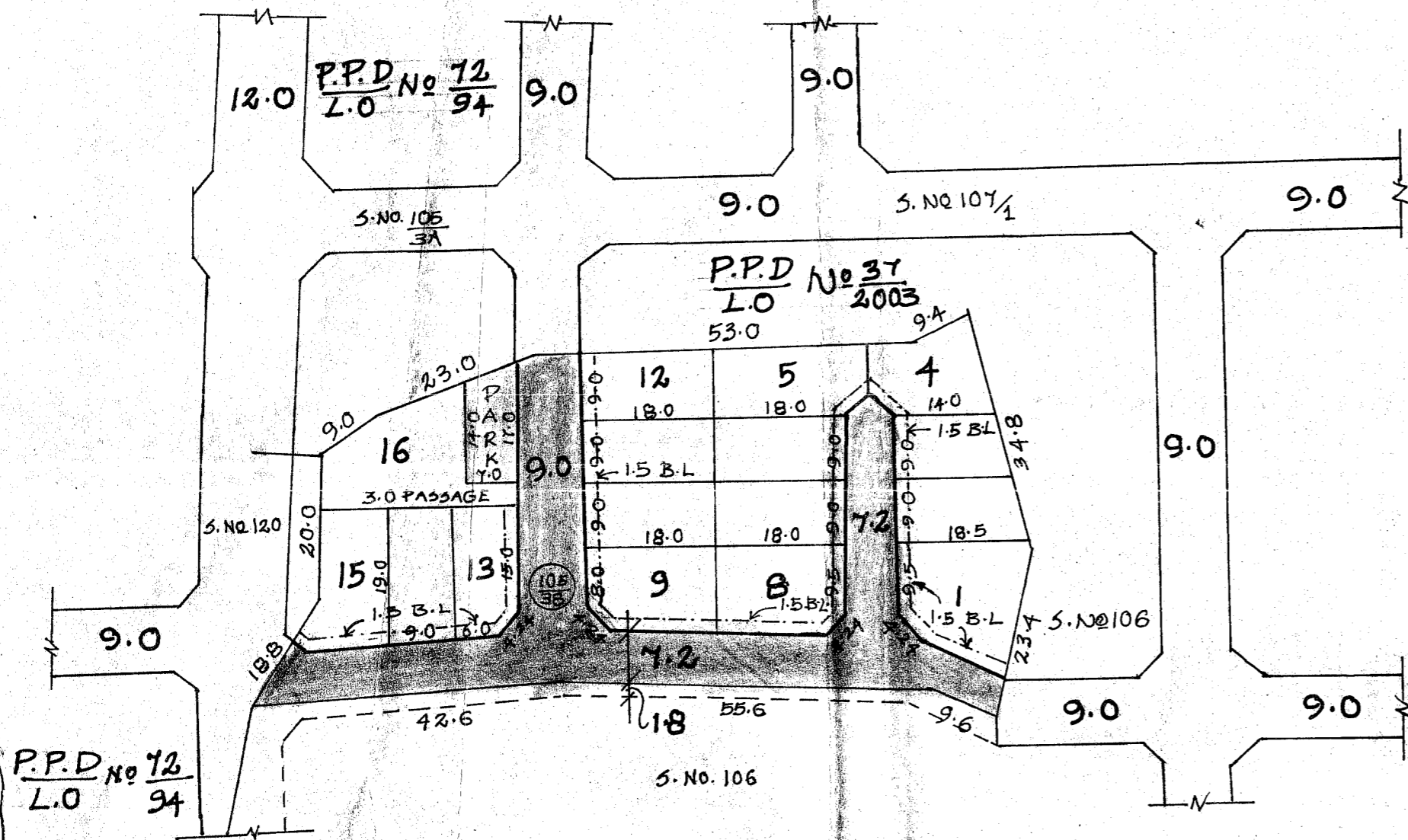

P.P.D. NO : 64<sup>16</sup>  
L.O : 2005  
APPROVED

VIDE LETTER NO : LI/7732/2005  
DATED : 8/7/2005

OFFICE COPY

FOR MEMBER SECRETARY  
CHENNAI METROPOLITAN  
DEVELOPMENT AUTHORITY

THIRUNINDRAVUR TOWN PANCHAYAT  
LAYOUT OF HOUSE SITES ' IN S.No.105/3B OF  
THIRUNINDRAVUR VILLAGE

SCALE : 1:800

