

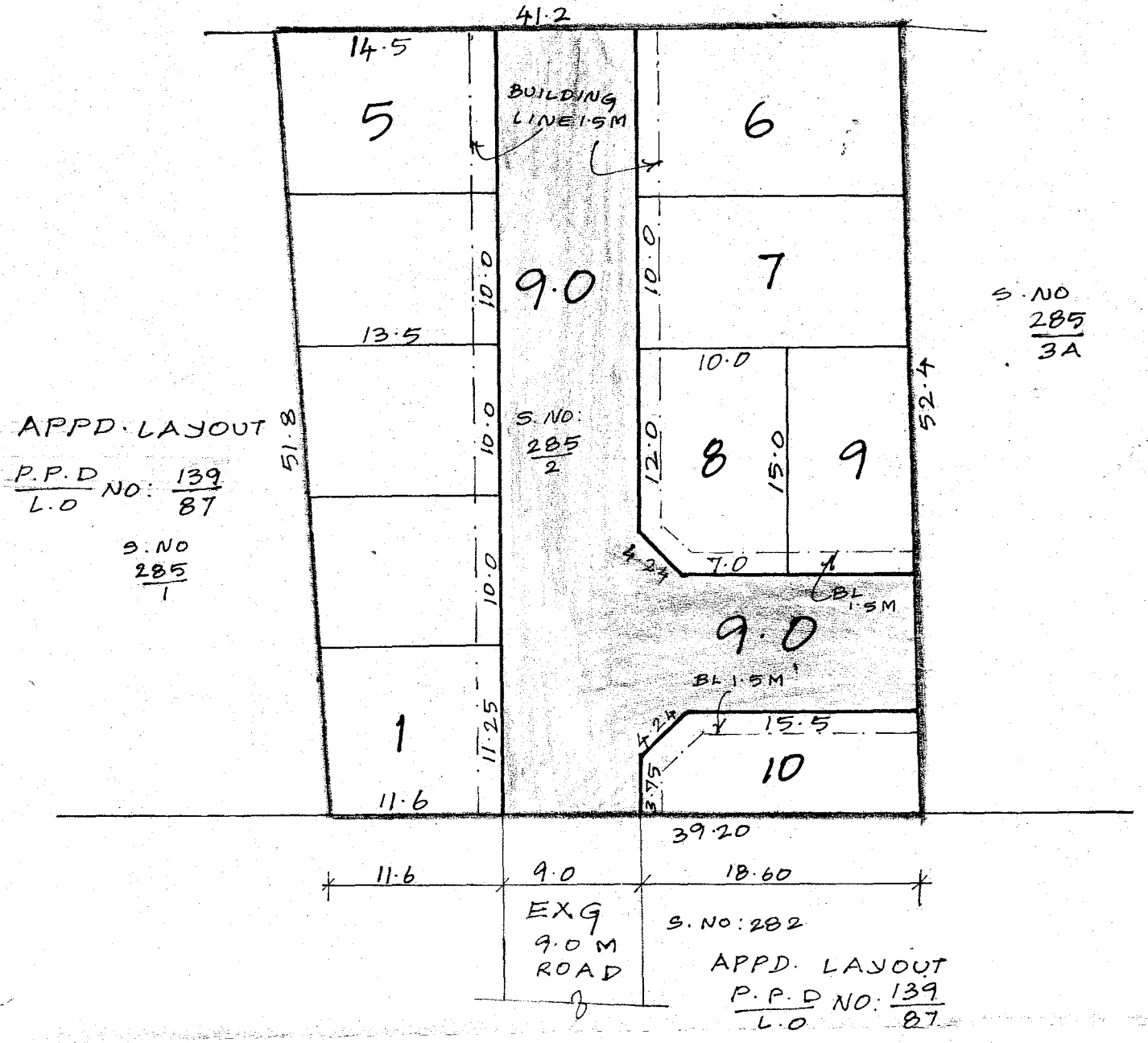



S. No: 313

C.M.D.A APPD. LAYOUT
 P.P.D NO: 139
 L.O NO: 87

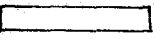

TOTAL EXTENT : 2093 M²
 ROAD AREA : 643 M²
 NO OF PLOTS : 10 NOS

NOTE
 1. SPLAY 3.0 M X 3.0 M
 2. MEASUREMENTS INDICATED ARE EXCLUDING SPLAY DIMENSIONS
 3. ROAD AREA ALREADY HANDED OVER TO THE LOCAL BODY VIDE GIFT DEED DOC NO: 9188/2004, DATED: 8/12/2004.

LEGEND
 SITE BOUNDARY
 EXISTING ROAD
 PROPOSED ROAD

P.P.D NO: 36 I.C
 L.O NO: 2005
APPROVED
 VIDE LETTER NO: L/38387/2004
 DATED: 29/4/2005
OFFICE COPY
 FOR MEMBER SECRETARY
 CHENNAI METROPOLITAN
 DEVELOPMENT AUTHORITY

PORUR TOWN PANCHAYAT

LAYOUT OF HOUSE SITES IN S.NO: 285/2 OF
 PORUR VILLAGE. SCALE: 1:400.

