

| | |
|-------------------------------|----------------------|
| TOTAL EXTENT | 13118 M ² |
| ROAD AREA | 4305 M ² |
| PARK AREA | 992 M ² |
| PUBLIC PURPOSE (I TO V PLOTS) | 1034 M ² |
| NO. OF PLOTS | 49 |
| REGULAR PLOTS 1 TO 37 | 37 |
| E.W.S. PLOTS 38 TO 49 | 12 |

- NOTE
1. SPLAY 3.0M X 3.0M
 2. MEASUREMENTS INDICATED ARE EXCLUDING SPLAY DIMENSIONS
 3. PARK AREA } ALREADY HANDED OVER TO THE LOCAL BODY
ROAD AREA } VIDE GIFTDEED DOC. NO 9772/2004 dt 23.12.2004

CONDITION :

THE AREA EARMARKED FOR PUBLIC PURPOSE I TO V (VIC. POST AND TELEGRAPH OFFICE, POLICE STATION ETC.) WOULD REMAIN RESERVED FOR A SPECIFIC PERIOD OF ONE YEAR FROM THE DATE OF APPROVAL TO ENABLE THE GOVERNMENT DEPARTMENT CONCERNED TO NEGOTIATE WITH THE OWNER AND ACQUIRED THE RESERVED LAND IF REQUIRED FOR THEM AFTER THE SAID PERIOD OF ONE YEAR, AND IF NONE OF THE AGENCIES PURCHASE THE RESERVED LAND FULL/PART, THE LAYOUT OWNER/ DEVELOPER IS FREE TO DISPOSE OF THE SITE RESERVED FOR PUBLIC PURPOSE TO ANY BODY FOR RESIDENTIAL USE ONLY.

- LEGEND.
- ▬ PROPOSED BOUNDARY
 - ▬ EXISTING ROAD
 - ▬ PROPOSED ROAD
 - ▬ PARK
 - ▬ PUBLIC PURPOSE
 - ▬ E.W.S. PLOTS

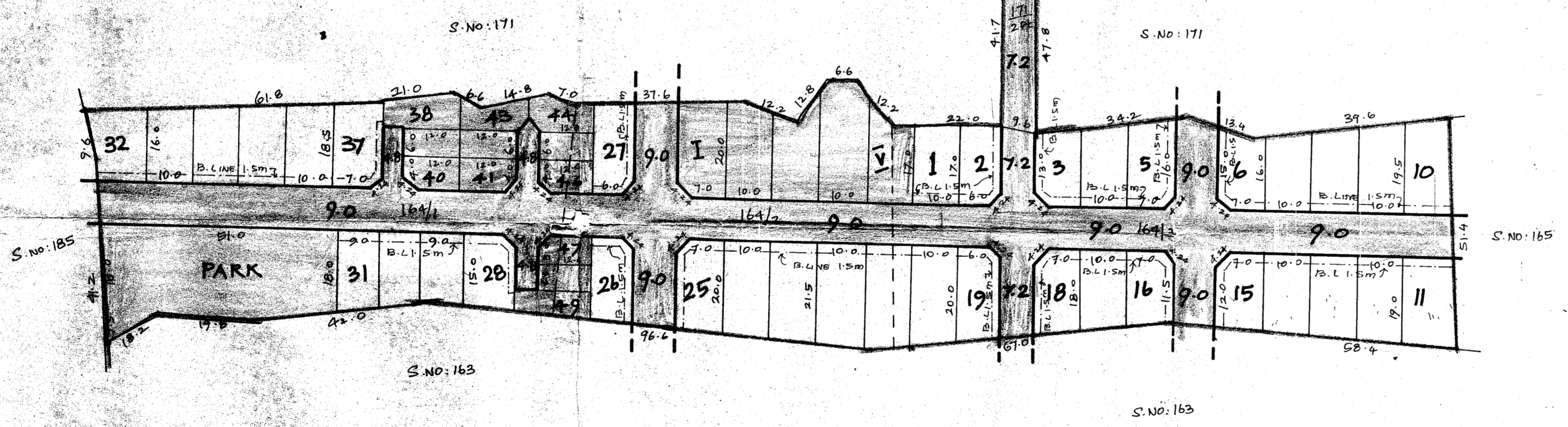

KUNDRATHUR TOWN PANCHAYAT
 LAY OUT OF HOUSE SITES IN S.NO: 164/1,2,3, 171/2Pt, 172/1Apt OF
 KUNDRATHUR VILLAGE.
 SCALE : 1:800

PPD NO 18
 LO NO 2005
 APPROVED
 VIDE LETTER NO L1/2891/05
 DATED 25.2.2005

FOR MEMBER SECRETARY
 CHENNAI METROPOLITAN
 DEVELOPMENT AUTHORITY

