

TOTAL EXTENT : 3750 M²
 ROAD AREA : 905 M²
 NO OF PLOTS : 20 Nos.



NOTE :-

1. SPLAY 3.0M X 3.0M.
2. MEASUREMENTS INDICATED ARE EXCLUDING SPLAY DIMENSIONS.
3. ROAD AREA WAS ALREADY HANDED OVER TO THE LOCAL BODY VIDE GIFT DEED, DOL NO: 2246/04, DT: 8-4-04

CONDITION :-

1. SEPTIC TANK WITH UPFLOW FILTER HAVE TO BE PROVIDED.

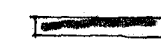
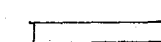
LEGEND :-

-  SITE BOUNDARY
-  EXISTING ROAD
-  PROPOSED ROAD.

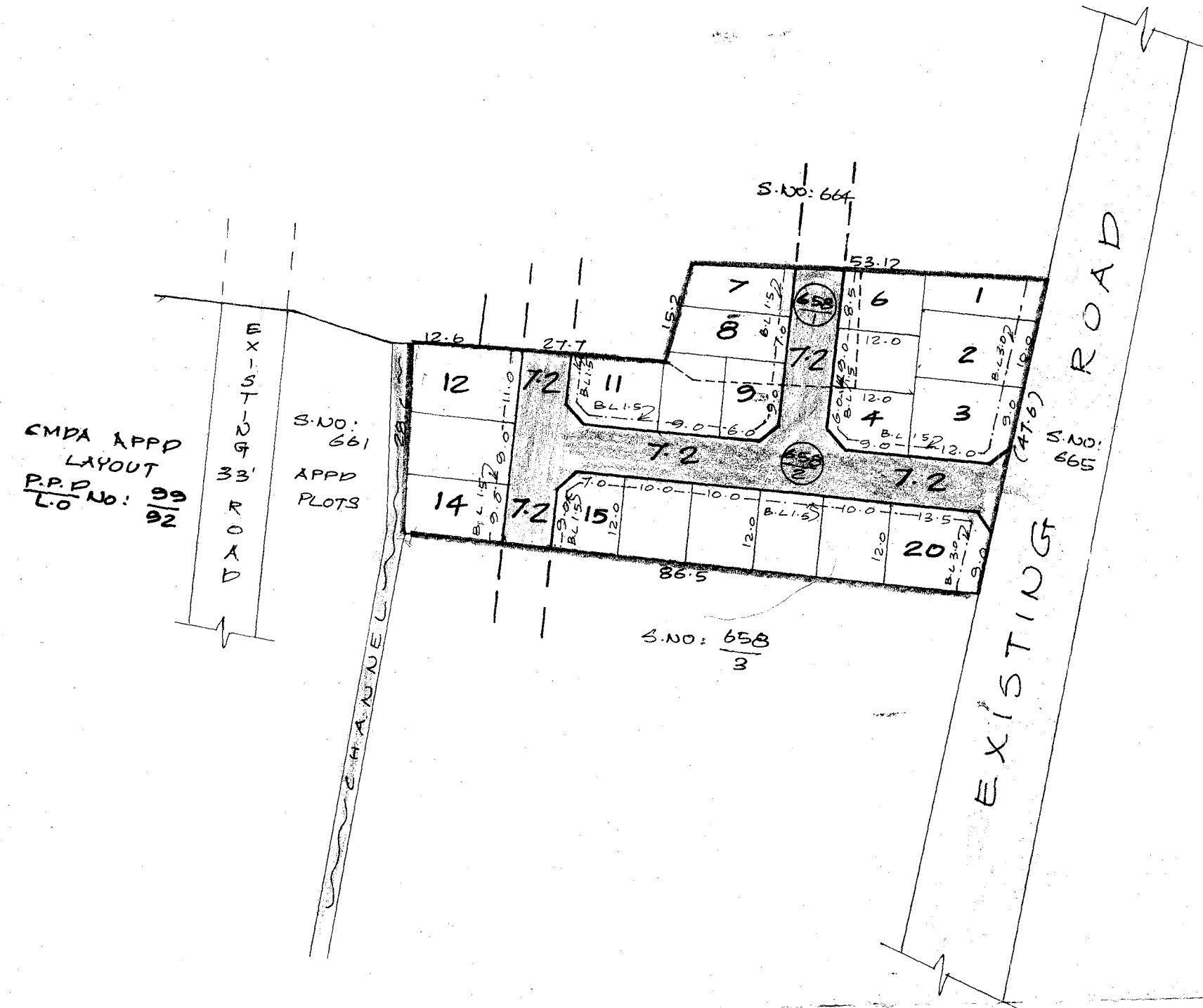

THIRUVALLUR PANCHAYAT UNION.
 LAYOUT OF HOUSE SITES IN S.NO: 658/1 AND 658/2 OF
 PAKKAM VILLAGE.

SCALE = 1:800

P.P.D NO: 461.C
 L.O NO: 2004

APPROVED.

VIDE LETTER NO: L1/11031/2004
 DATED : 06-05-2004

OFFICE COPY

FOR MEMBER SECRETARY
 CHENNAI METROPOLITAN
 DEVELOPMENT AUTHORITY

