

TOTAL EXTENT : 1694 M²
 ROAD AREA : 425 M²
 NO OF PLOTS : 12 NOS

NOTE :-
 1. SPLAY 3.0M X 3.0M
 2. MEASUREMENTS INDICATED ARE EXCLUDING SPLAY DIMENSIONS
 3. ROAD AREA WAS ALREADY HANDED OVER TO THE LOCAL BODY
 VIDE GIFT DEED DOC. NO: 2978/04 DT: 14/10/04

LEGEND :-
 [Symbol] SITE BOUNDARY
 [Symbol] PROPOSED ROAD
 [Symbol] EXISTING ROAD

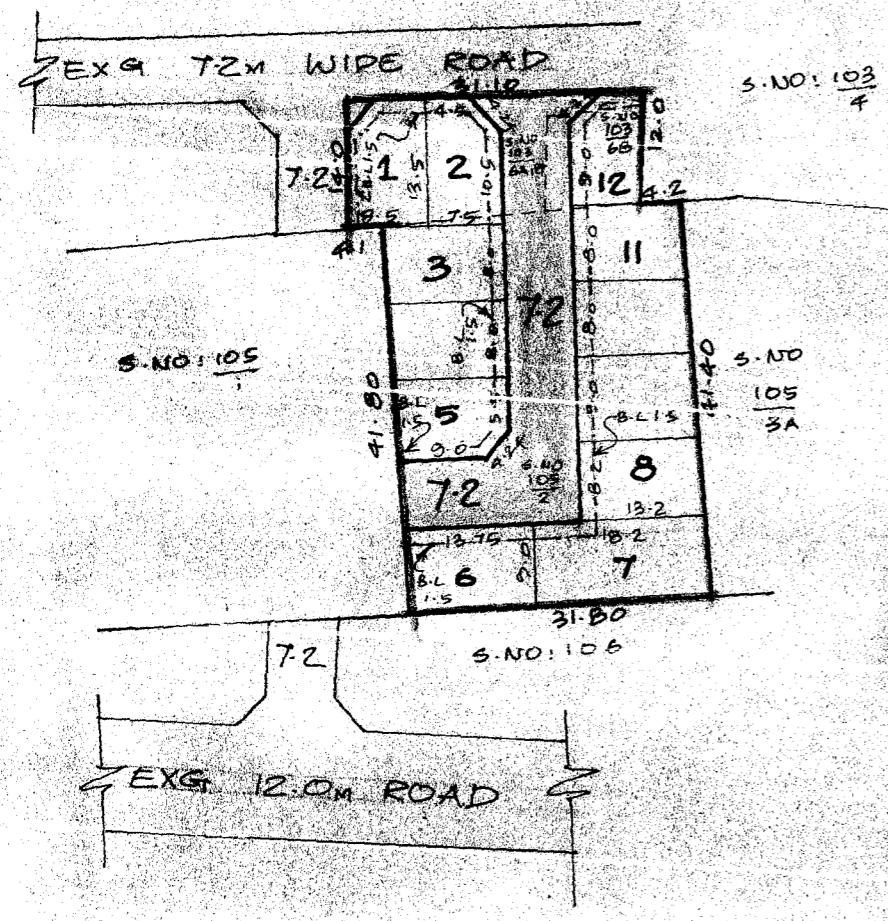

PERUNGULATHUR TOWN PANCHAYAT.

LAYOUT OF HOUSE SITES IN S.NO: 103/6A/PT, 103/6B AND 105/2 OF PERUNGULATHUR VILLAGE.

SCALE :- 1:800

P.P.D NO: 125 I.C
 L.O NO: 2004

APPROVED

VIDE LETTER NO: LI/26434/2004
 DATED: 08-11-2004

OFFICE COPY

FOR MEMBER SECRETARY
 CHENNAI METROPOLITAN
 DEVELOPMENT AUTHORITY

