

TOTAL EXTENT : 7041 Sqm
 ROAD AREA : 1500 Sqm
 No. OF PLOTS : 23 nos

NOTE:
 1. SPLAY 3.00m x 3.00m
 2. MEASUREMENTS INDICATED ARE EXCLUDING SPLAY DIMENSION
 3. ROAD AREA ALREADY HANDED OVER TO THE LOCAL BODY VIDE GIFT DEED DOC NO: 660/2003 DATED : 6.3.2003

LEGEND:
 [Symbol] SITE BOUNDARY
 [Symbol] EXISTING ROADS
 [Symbol] PROPOSED ROADS

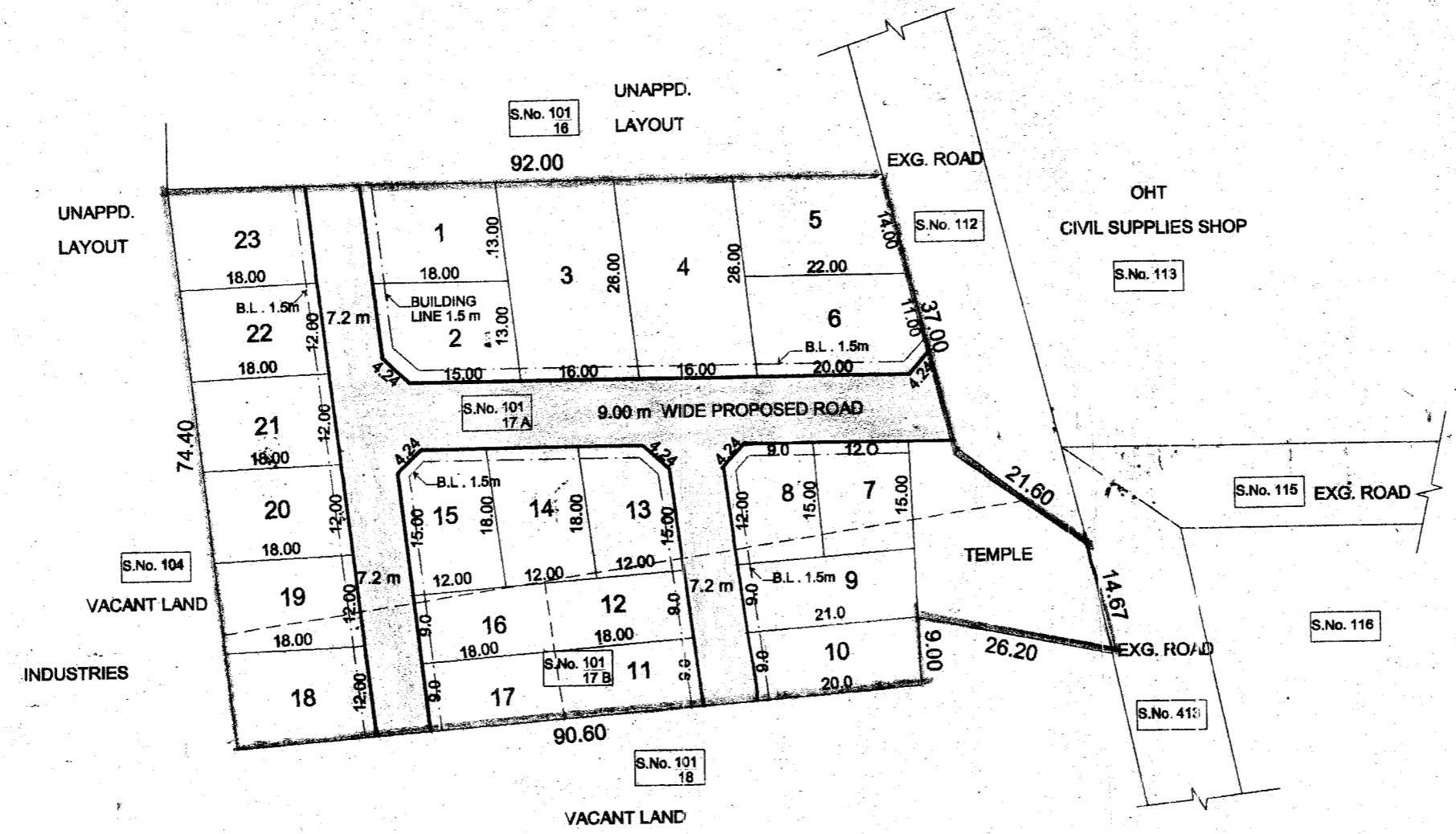

ST. THOMAS MALAI PANCHAYAT UNION
 LAYOUT OF HOUSE SITES IN S.No. 101/17A AND 101/17B OF
 OKKIAM THORAIPAKKAM VILLAGE
 SCALE: 1:800

P.P.D L.O No: 28/14
 2003
Layout revised no 63
APPROVED
 2003
 VIDE LETTER No : L1/7720/2003
 DATED : 31/03 2003

(OFFICE COPY)

FOR MEMBER SECRETARY
 CHENNAI METROPOLITAN
 DEVELOPMENT AUTHORITY

