

TOTAL EXTENT (3.36 AC)	: 13597 M ²
ROAD AREA	: 4070 M ²
PARK AREA	: 977 M ²
PUBLIC PURPOSE PLOTS (I TO VII)	: 966 M ²
TOTAL NO OF PLOTS	: 51
EWS PLOTS	: 11
REGULAR PLOTS	: 40
SHOP SITE	: 1

NOTE:

1. SPLAY 10' x 10'
 2. MEASUREMENTS INDICATED ARE EXCLUDING SPLAY DIMENSION.
- ROAD AREA WAS ALREADY HANDED OVER TO THE LOCAL BODY
 PARK AREA VIDE GIFT DEED DOC. NO. 1518 DATED 9.7.02.

CONDITION:

THE AREA EARMARKED FOR PUBLIC PURPOSE I TO VII (VIZ. POST AND TELEGRAPH OFFICE, POLICE STATION ETC) WOULD REMAIN RESERVED FOR A SPECIFIC PERIOD OF ONE YEAR FROM THE DATE OF APPROVAL TO ENABLE THE GOVERNMENT DEPT. CONCERNED TO NEGOTIATE WITH THE OWNER AND ACQUIRE THE RESERVED LAND IF REQUIRED FOR THEM AFTER THE SAID PERIOD OF ONE YEAR, AND IF NONE OF THE AGENCIES PURCHASE THE RESERVED LAND FULL/PART, THE LAYOUT OWNER/DEVELOPER IS FREE TO DISPOSE OFF THE SITE RESERVED FOR PUBLIC PURPOSE TO ANYBODY FOR RESIDENTIAL USE ONLY.

LEGEND:

- SITE BOUNDARY
- PROPOSED ROAD
- EXISTING ROAD
- PARK
- PUBLIC PURPOSE
- E.W.S.
- COMMERCIAL SITE

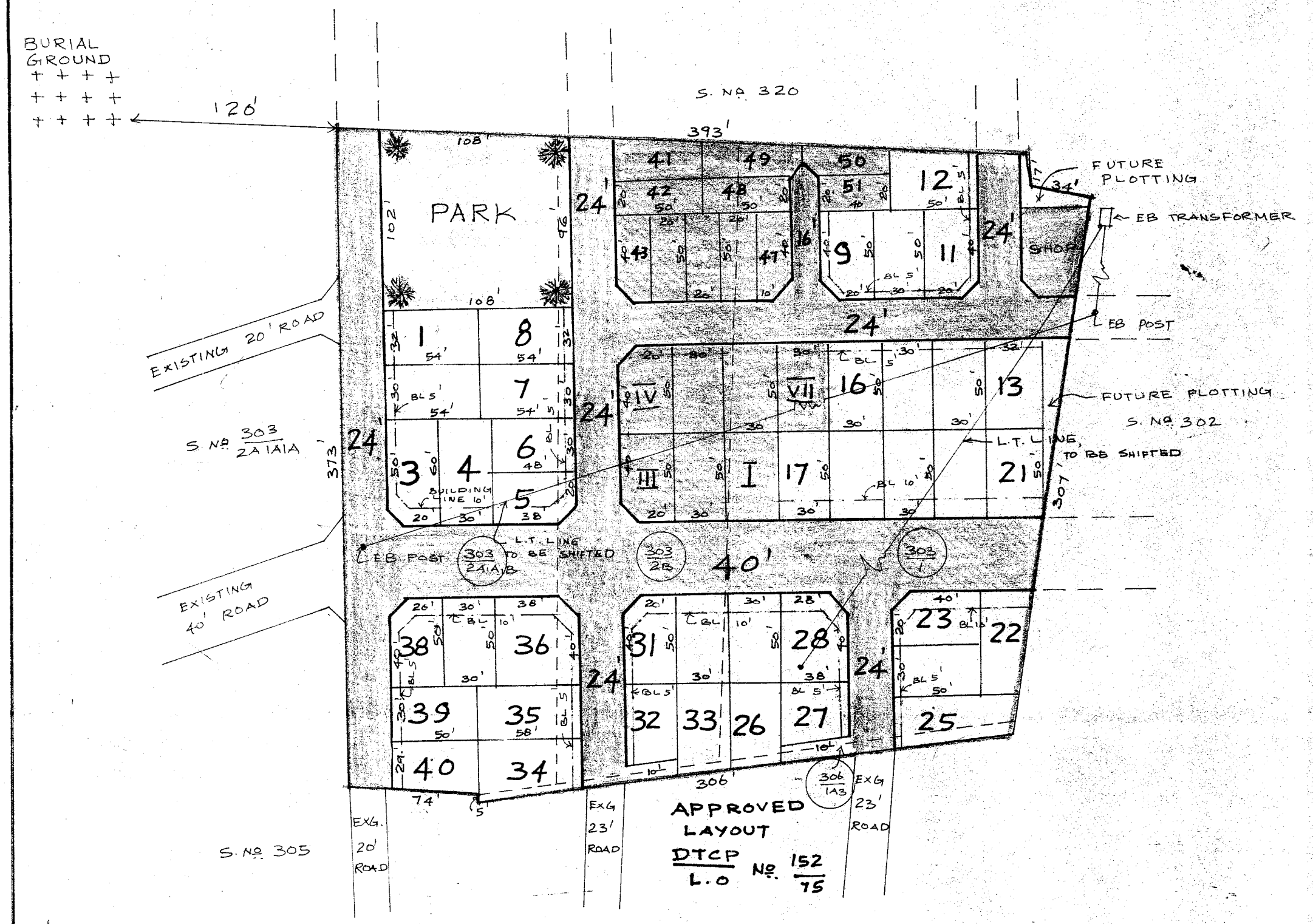

P.P.D No. 62 IC
L.O No. 2002

APPROVED
VIDE LETTER NO: LI/30451/2002
DATED: 04/10/2002

OFFICE COPY

FOR MEMBER SECRETARY
CHENNAI METROPOLITAN
DEVELOPMENT AUTHORITY.

PERUNGALATHUR TOWN PANCHAYAT
LAYOUT OF HOUSE SITES IN S.No. 303/1, 303/2B, 303/2A1A1B
AND 306/1A3 OF PERUNGALATHUR VILLAGE
SCALE: 66 FEET TO AN INCH.

