

MAILED

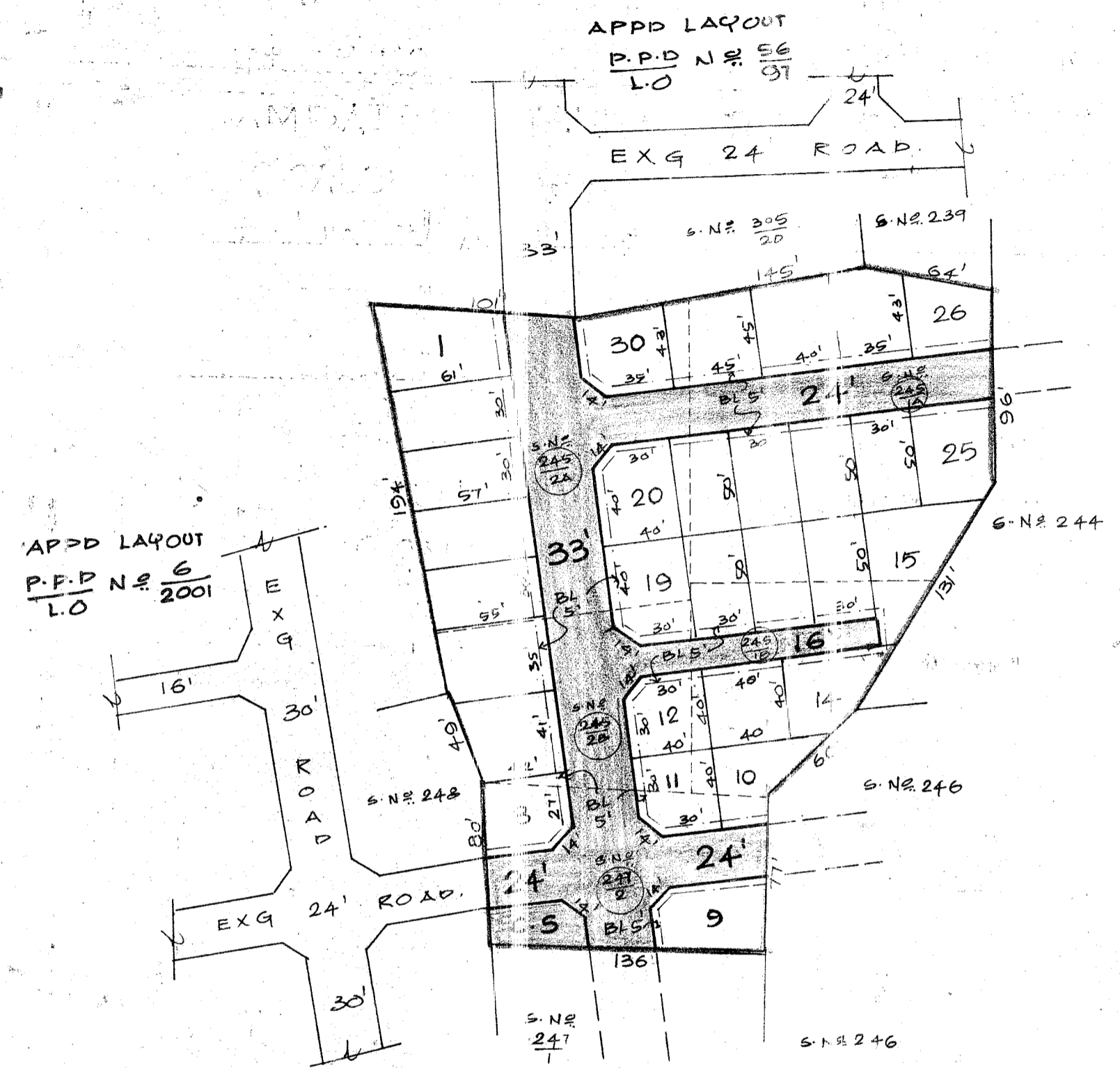

TOTAL EXTENT (1.68 AC) : 6799 M²
 ROAD AREA : 1898 M²
 PLOTTABLE AREA : 4901 M²
 N.º OF PLOTS : 30 N.ºS
 CONVENIENCE SHOP : 1 N.º

LEGEND :

- SITE BOUNDARY.
- EXISTING ROAD
- PROPOSED ROAD.
- CONVENIENCE SHOP.

NOTE :

1. SPLAY 10' X 19'
2. MEASUREMENTS INDICATED ARE EXCLUDING SPLAY DIMENSION.
3. ROAD AREA ALREADY HANDED OVER TO THE LOCAL BODY VIDE GIFT DEED DOC. N.º 3854/2001 DATED : 29.11.2001.

K. S. S. S. S.
 TRACED BY

C. Rami Prudh...
 P. A. T. P.

Manick...
 9/1/2002

V. S. S. S.
 11/1/2002

P.P.D N.º 2
 L.O 2002

APPROVED.

VIDE LETTER N.º : L/39853/2002
 DATED : / 01 / 2002

S/S
 FOR MEMBER SECRETARY
 CHENNAI METROPOLITAN
 DEVELOPMENT AUTHORITY.

VILLIVAKKAM PANCHAYAT UNION
 LAYOUT OF HOUSE SITES IN S.N.º 245/1A, 1B, 2A, 2B & 247/2
 OF NOLAMBUR VILLAGE.
 SCALE : 66 FEET TO AN INCH.

